

# sumiMill Series Indexable Shell Mills

## Square Shoulder Face Mill

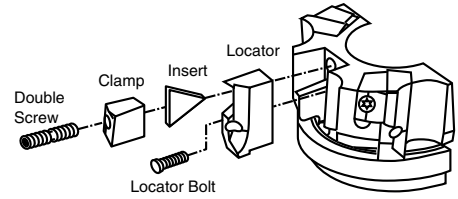

### CPG 400 & 500 Face Mill Series

\*Lead Angle: 0°  
\*Axial Rake Angle: +6°  
\*Radial Rake Angle: 0°, 2° for 5XX Series

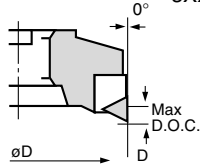

Fig. 1

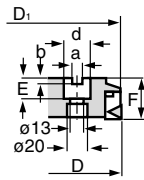

Fig. 2

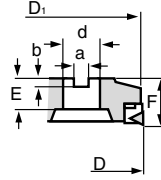
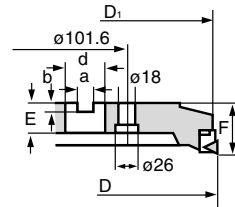

Fig. 3



Catalog Number	Dimensions							No. of Teeth	Max. D.O.C.	Fig.	I.C.
	D	D <sub>1</sub>	F	d	a	b	E				
CPG504R*	4.000	4.000	2.362	1.500	0.625	0.406	1.781	.700	1	5/8	
CPG505R*	5.000	5.000	2.362	1.500	0.625	0.406	1.781		2		
CPG506R**	6.000	6.000	2.362	2.000	0.750	0.437	1.781		3		
CPG508R	8.000	8.000	2.362	2.500	1.000	0.531	1.781	.630	1	1/2	
CPG03R	3.150	3.150	1.969	1.000	0.375	0.234	0.984		5		
CPG04R*	4.331	4.331	2.362	1 1/2	0.625	0.390	1.781		6		
CPG05R*	4.921	4.921	2.362	1.500	0.625	0.390	1.781	8	2		
CPG06R**	6.299	6.299	2.362	2.000	0.750	0.437	1.781	10			

\*Requires BFX3/4x16 arbor screw

\*\*Requires BFX1x14 arbor screw

### Inserts

Sumitomo Cat. No.	Figure 1				Figure 2				Figure 3			
	Coated		Cermet	Uncoated	Ceramic		Dimensions (Inches)					
	AC230	AC325	AC211	EH20Z	T250A	A30N	G10E	NS30	I.C.	T	R	Figure
TPCH43R									0.500	0.1875	-	1
TPCH43TR												
TPC53P12R									0.625	0.1875	0.0156	2
TPC53P12RA												
TPG431									0.500	0.1875	0.0312	3
TPG432												
TPG433									0.500	0.1875	0.0469	
TPG434												
TPG436									0.500	0.1875	0.0938	
TPMN431												
TPMN432									0.500	0.1875	0.0156	
TPMN433												
TPMN434									0.500	0.1875	0.0312	
TPMN433												
TPMN434									0.500	0.1875	0.0469	
TPMN433												
TPMN434									0.500	0.1875	0.0625	
TPMN433												

"T" denotes inserts with a T-Land.

### Hardware for 400 Series

Catalog Number	Locator	Clamp	Clamp Bolt	Locator Bolt	Wrench
CPG03R		PTW40R			TT27
CPG04R	LCP40R	PTW41R	WB8-24T	BX0510	
CPG05R					LH040
CPG06R					

### Hardware for 500 Series

Catalog Number	Locator	Clamp	Clamp Bolt	Locator Clamp Bolt	Wrench	Wrench
CPG504R		PTW50R			TT27	TT25
CPG505R	LCP50R	PTW51R	WB8-24T	BH0408		
CPG506R						
CPG508R						
CPG510R						

**See pages 92-93**  
**For recommended running parameters**