

LTR	ECA NO	BY	CHKD	APPD	ISSUE DATE
1	ER 99-86	RWC		PROTOTYPE	
A	ER 01-036	JGE		REL FOR MFG	3/30/01
B	01-036	AM	RWC		10/10/01

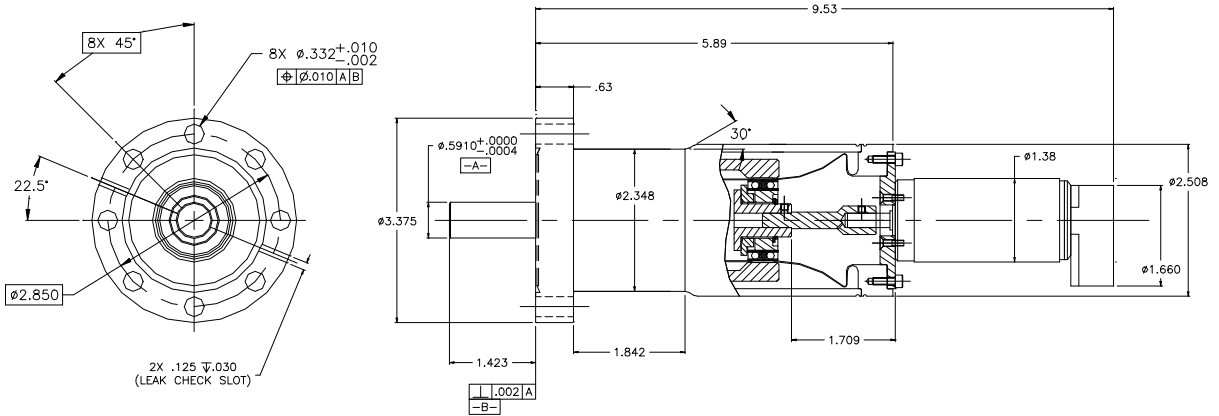

NOTES:

- SEAT COPPER GASKET ON FACE OF OUTPUT FLANGE OF HOUSING.
- SECURE 3 3/8" CONFLAT FLANGE TO VACUUM CHAMBER WITH (8) 5/16-24 UNF STAINLESS STEEL SHCS.

Notice:
 All specifications and dimensions shown in the drawing are subject to change without notice. This drawing is the property of Harmonic Drive LLC. This data is believed to be accurate, however, Harmonic Drive LLC assumes no liability for any errors or omissions in the specifications, models or drawings.

Harmonic Drive LLC
 Tel: 800-921-3332
 www.harmonicdrive.net

UNLESS OTHERWISE SPECIFIED		ISSUE DATE
DIMENSIONS ARE IN INCHES		CONTRACT NO.
TOLERANCES ON UNMACHINED SURFACES		
FINISH	ANGLES	DESIGNER
±.005	±.01	±2°
UNIFORM	WELDING	DATE
RWC 11/4/99	MAG. 3/30/01	12/15/99
UNIFORM	QUALITY	DATE
RWC 11/4/99	100%	3/30/01
UNIFORM	DATE	
RWC 11/4/99	3/30/01	
UNIFORM	DATE	
RWC 11/4/99	3/30/01	
UNIFORM	DATE	
RWC 11/4/99	3/30/01	



Harmonic Drive LLC
 800-921-3332
 www.harmonicdrive.net

INSTALLATION
 HHA-014-YY

REV	DESCRIPTION	DATE	BY
1	34519	1010480	B

SCALE 1:1 SHEET 1 OF 1