

LTR	ECA NO	BY	CHKD	APPD	ISSUE DATE
A	ER 99-54	RWC	RELEASED TO MFG		8-16-99
B	99-203	JOE	RWC		12/6/99
C	00-034	JOE	RWC		3/30/00
D	00-151	JOE			10/30/00

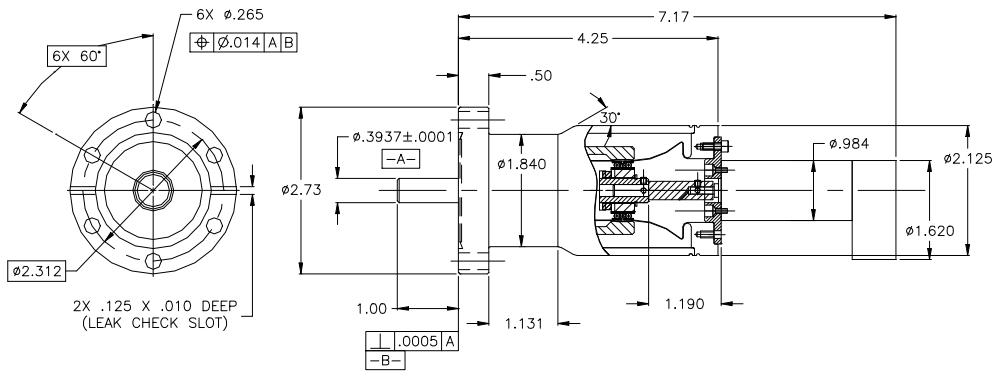

NOTES:

- SEAT COPPER GASKET ON FACE OF OUTPUT FLANGE OF HOUSING.
- SECURE HHA UNIT TO VACUUM CHAMBER WITH (6) 1/4 X 28 X 'L' BOLTS, WHERE THE BOLT LENGTH 'L' IS DEPENDENT UPON DEPTH OF TAPPED HOLE ON CUSTOMERS VACUUM CHAMBER.

Notice:  
 All specifications and dimensions shown in the drawing are subject to change without notice. This drawing is the property of Harmonic Drive LLC. This data is believed to be accurate, however; Harmonic Drive LLC assumes no liability for any errors or omissions in the specifications, models or drawings.

Harmonic Drive LLC  
 Tel:800-921-3332  
 www.harmonicdrive.net

UNLESS OTHERWISE SPECIFIED: DIMENSIONS ARE IN INCHES TOLERANCES ON FINISHED DIMENSIONS:		DATE	
2 PLACE DECIMALS	3 PLACE DECIMALS	CONTRACT NO.	
ANGLES	ANGLES	DRAWN	DESIGNER
±.005	±.01	RGB 5/7/98	LG 5/7/98
	±2°	WELDED	DESIGN ENCL.
MACHINED SURFACES	✓ ±.3	WELDING DATE	DATE
		JOH 8/9/99	JOE 8/9/99
		SUBMITTED	
		SIMILAR TO	

Harmonic Drive LLC  
 800-921-3332  
 www.harmonicdrive.net

**INSTALLATION**  
 HHA-010-YY

REV. 1 OF 1

34519 1010474

SCALE: None UNIT: IN.