

LED WAY/ROAD ILLUMINATION SERIES

LED Streetlight/Road Headpiece Series

LB-J2018-000 L-BOT



Light Source: 1W high power LEDs
 Color Temperature: 2000K ±200K
 6500K ±500K

Luminous Flux: 1800lm
 Central Illumination: 75Lux/4m
 Beam Angle: Horizontal: 120° Vertical: 65°
 Input Voltage, Frequency: 100-240V AC,
 50/60HZ
 LED Working Voltage: 24VDC
 Total LED Power : 38W
 Installation Tube Diameter: Ø50mm(Max)
 Operating temperature: -30°C - +40°C

CE U L IP65

30 LED Streetlight Headpiece

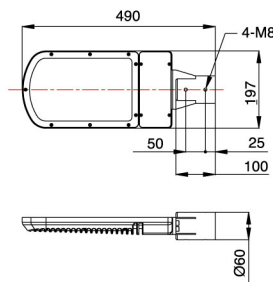
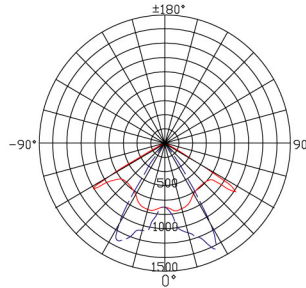

LB-J2019-000 L-BOT



Light Source: 1W high power LEDs
 Color Temperature: 2000K ±200K
 6500K ±500K

Luminous Flux: 3880lm
 Central Illumination: 70Lux/6m
 Beam Angle: Horizontal: 120° Vertical: 65°
 Input Voltage, Frequency: 100-240V AC,
 50/60HZ
 LED Working Voltage: 24VDC
 Total Power Input: 78 W
 Installation Tube Diameter: Ø60mm(Max)
 Operating temperature: -30°C - +40°C

CE U L IP65

60 LED Streetlight Headpiece

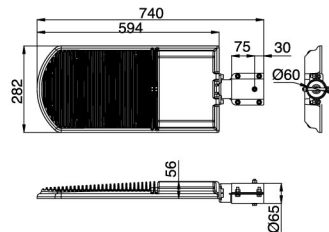
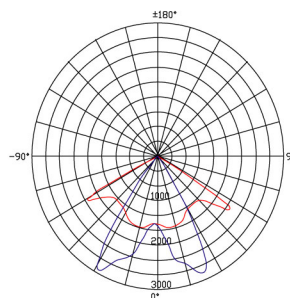

LED WAY/ROAD ILLUMINATION SERIES

LED Streetlight/Road Headpiece Series

LB-J2020-000 L-BOT



Light Source: 1W high power LED
 Color Temperature: 2000K ±200K
 6500K ±500K
 Luminous Flux: 5860lm
 Central Illumination: 56Lux/8m
 Beam Angle: Horizontal: 120° Vertical: 65°
 Input Voltage, Frequency: 100-240V AC,
 50/60HZ
 LED Working Voltage: 24VDC
 Total LED Power : 118W
 Installation Tube Diameter: Ø60mm(Max)
 Operating temperature: -30°C - +40°C
CE **U** **◆** **▲** **▲** IP65

90 LED Streetlight Headpiece

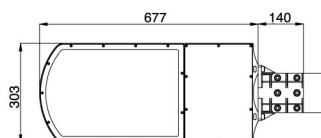
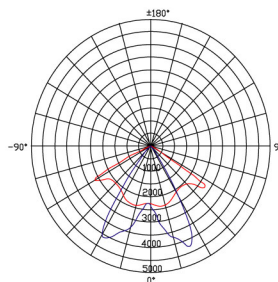

LB-J2021-000 L-BOT



Light Source: 1W high power LEDs
 Color Temperature: 2000K ±200K
 6500K ±500K
 Luminous Flux: 8110lm
 Central Illumination: 54Lux/10m
 Beam Angle: Horizontal: 120° Vertical: 65°
 Input Voltage, Frequency: 100-240V AC,
 50/60HZ
 LED Working Voltage: 24VDC
 Total LED Power : 155W
 Installation Tube Diameter: Ø60mm(Max)
 Operating temperature: -30°C - +40°C
CE **U** **◆** **▲** **▲** IP65

120 LED Streetlight Headpiece

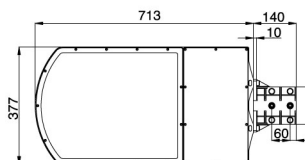
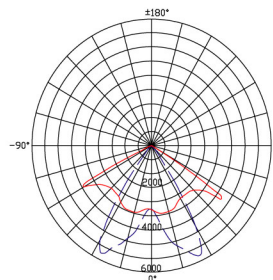

LED WAY/ROAD ILLUMINATION SERIES

LED Streetlight/Road Headpiece Series

LB-J2018-001 L-BOT

30 LED Street Light Headpiece



Light Source:1W high power LEDs
 Color Temperature: 2000K ±200K
 6500K ±500K
 Luminous Flux: 1800lm
 Central Illumination: 75Lux/4m
 Beam Angle: Horizontal:120° Vertical:65°
 Input Voltage,Frequency: 100-240V AC, 50/60HZ
 LED Working Voltage:24VDC
 Total LED Power : 38W
 Installation Tube Diameter: Ø50mm(Max)
 Operating temperature: -30°C - +40°C

Street Light Operation Guidance:

- 1, In evening, when outdoor illuminance is lower than 20Lux, the light is turned on automatically. Otherwise, it keeps off.
- 2, During the 10 hours setting periods of lighting, the light works at its max power in the first 6 hours and works at its half max power in the next 4 hours. After that, it turns off automatically.

Remark: When the outdoor illuminance is lower than 20Lux, the street light turns on automatically; And it turns off when above 50 Lux. Switching from on to off or off to on needs 5 mins.

- 3, The above setting can only be programmed by the factory professionals before shipping out.

CE U IP65

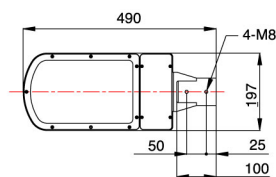
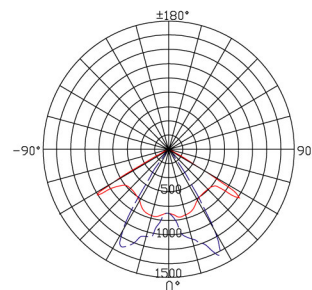

LB-J2019-001 L-BOT

60 LED Street Light Headpiece



Light Source:1W high power LEDs
 Color Temperature: 2000K ±200K
 6500K ±500K
 Luminous Flux: 3880lm
 Central Illumination: 70Lux/6m
 Beam Angle: Horizontal:120° Vertical:65°
 Input Voltage,Frequency:100-240V AC, 50/60HZ
 LED Working Voltage:24VDC
 Total Power Input:78 W
 Installation Tube Diameter: Ø60mm(Max)
 Operating temperature: -30°C - +40°C

Street Light Operation Guidance:

- 1, In evening, when outdoor illuminance is lower than 20Lux, the light is turned on automatically. Otherwise, it keeps off.
- 2, During the 10 hours setting periods of lighting, the light works at its max power in the first 6 hours and works at its half max power in the next 4 hours. After that, it turns off automatically.

Remark: When the outdoor illuminance is lower than 20Lux, the street light turns on automatically; And it turns off when above 50 Lux. Switching from on to off or off to on needs 5 mins.

- 3, The above setting can only be programmed by the factory professionals before shipping out.

CE U IP65

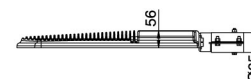
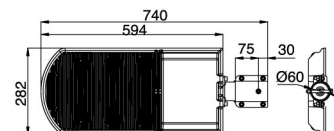
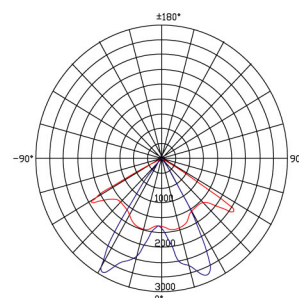

LED WAY/ROAD ILLUMINATION SERIES

LED Streetlight/Road Headpiece Series

LB-J2020-001 L-BOT



Light Source: 1W high power LED
 Color Temperature: 2000K ±200K
 6500K ±500K
 Luminous Flux: 5860lm
 Central Illumination: 56Lux/8m
 Beam Angle: Horizontal: 120° Vertical: 65°
 Input Voltage, Frequency: 100-240V AC, 50/60HZ
 LED Working Voltage: 24VDC
 Total LED Power : 118W
 Installation Tube Diameter: Ø60mm(Max)
 Operating temperature: -30°C - +40°C
 Street Light Operation Guidance:

- 1, In evening, when outdoor illuminance is lower than 20Lux, the light is turned on automatically. Otherwise, it keeps off.
- 2, During the 10 hours setting periods of lighting, the light works at its max power in the first 6 hours and works at its half max power in the next 4 hours. After that, it turns off automatically.
 Remark: When the outdoor illuminance is lower than 20Lux, the street light turns on automatically; And it turns off when above 50 Lux. Switching from on to off or off to on needs 5 mins.
- 3, The above setting can only be programmed by the factory professionals before shipping out.

CE U IP65

90 LED Street Light Headpiece

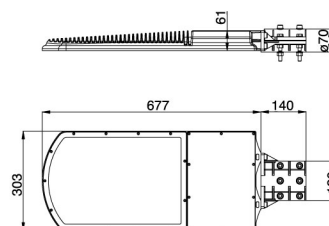
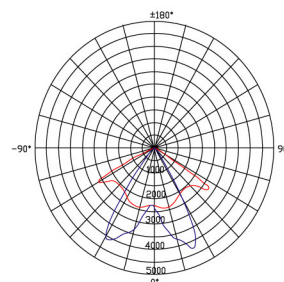

LB-J2021-001 L-BOT



Light Source: 1W high power LEDs
 Color Temperature: 2000K ±200K
 6500K ±500K
 Luminous Flux: 8110lm
 Central Illumination: 54Lux/10m
 Beam Angle: Horizontal: 120° Vertical: 65°
 Input Voltage, Frequency: 100-240V AC, 50/60HZ
 LED Working Voltage: 24VDC
 Total LED Power : 155W
 Installation Tube Diameter: Ø60mm(Max)
 Operating temperature: -30°C - +40°C
 Street Light Operation Guidance:

- 1, In evening, when outdoor illuminance is lower than 20Lux, the light is turned on automatically. Otherwise, it keeps off.
- 2, During the 10 hours setting periods of lighting, the light works at its max power in the first 6 hours and works at its half max power in the next 4 hours. After that, it turns off automatically.
 Remark: When the outdoor illuminance is lower than 20Lux, the street light turns on automatically; And it turns off when above 50 Lux. Switching from on to off or off to on needs 5 mins.
- 3, The above setting can only be programmed by the factory professionals before shipping out.

CE U IP65

120 LED Street Light Headpiece

