



SaVi SHO™
Super High Output

A new architectural Super High Output full spectrum (RGB) LED floodlight. It features the world's brightest RGB LED lighting system for unmatched performance. *Patent Pending

CAPABILITIES

- 2X brighter than competitive LED flood lights
- 16 million colors fully controllable by DMX
- Integral auto switching power supply (AC 115-240V)
- Unlimited color effects include static colors, cross fading, chasing and single color rotation
- Bottom and side conduit entrances and completely sealed for wet location applications
- Constructed of cast aluminum alloy

SPECIFICATIONS

- Color Range:** Different brightness of red, green and blue combined to produce over 16 million colors.
- Light Source:** LTCC-M High density RGB array
- Optic Angles:** 45°, 30°
- Fixture Spacing:** 20' (5m)
- Control System:** DMX512
- Housing Material:** Cast aluminum alloy
- Wiring:** Hard wire through bottom and side conduit entrances
- Dimension:** L330mm x W143mm x H240 (L13.0" x W5.7" x H9.5")
- Regular Working Voltage:** AC 115-240V
- Mounting:** Easy to install back mounting plate - wall, ceiling or pad mount
- Current:** 2A max
- Wattage:** 90W
- Warranty:** 2 years
- IP Rating:** IP66
- Life:** 50,000 hours

+

COLOR

+

LIGHT



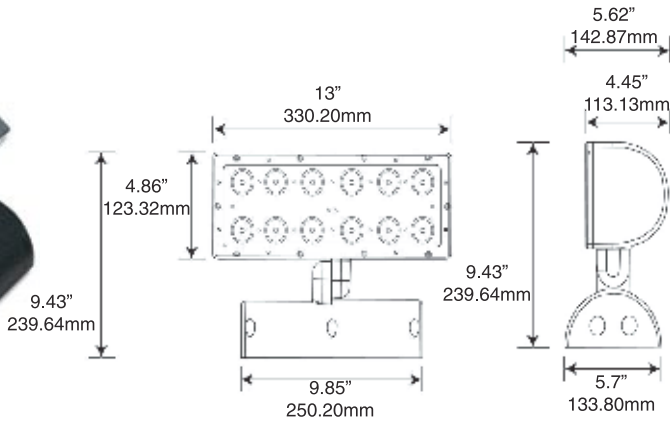

Project: _____
 Type: _____
 Voltage: _____
 Notes: _____



DESCRIPTION

SaVi™ SHO is an architectural line voltage, Super High Output full spectrum (RGB) LED floodlight with self contained auto switching power supply. It features the world's brightest RGB LED lighting system utilizing patented laminated ceramic technology and a special heat sinking system for superior life. It is capable of 16 million colors and is fully controllable by DMX. Color effects include static colors, cross fading, chasing and single color rotation. The sealed housing is constructed of cast aluminum alloy.

SPECIFICATION FEATURES

Color Range: Different brightness of red, green and blue combined to produce over 16 million colors.
Light Source: LTCC-M High density RGB array
Optic Angles: 45°, 30°
Fixture Spacing: 20' (5m)

Control System: DMX512
Housing Material: Cast aluminum alloy
Wiring: Hard wire through bottom and side conduit entrances
Dimension: L330mm x W143mm x H240 (L13" x W5.7" x H9.5")
Regular Working Voltage: AC 115-240V

Mounting: Easy to install back mounting plate
Current: 2A max
Wattage: 90W
Warranty: 2 years
IP Rating: IP66
Life: 50,000 hours



PHOTOMETRICS - 30° Optics

LED Lumen Output 1416	
Max candela	652.5
Vertical beam angle	67.1°
Horizontal beam angle	100.9°
Vertical field angle	95.7°
Horizontal field angle	113.1°
Total Fixture Lumens	1202
Field Lumens	1202
Beam Lumens	864.2
Total Fixture Efficiency	83.5%
Field Efficiency	83.5%
Beam Efficiency	60%

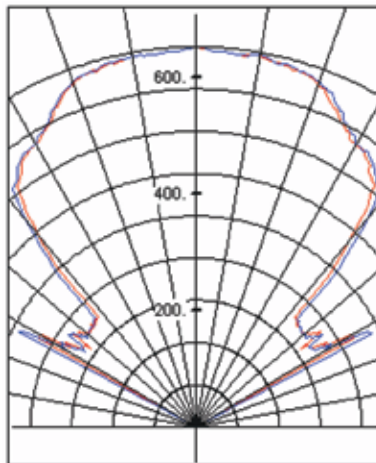

COLOR MODES

Static Display: Capable of 16 million colors
Flashing Change: Color transition from high brightness to low brightness
Cross Fade: Colors alternate
Color Chase: Colors chase one another
Auto Color Selection/Change: Colors rotate automatically or are static without DMX applied based on 10 preset selections.

ORDERING INFORMATION

MODEL

SaVi-SHO - Architectural Full Spectrum RGB LED Fixture

OPTICS

30 - 30° Optics
45 - 45° Optics

FIXTURE COLOR

005 - Silver
004 - Black (Std.)
003 - White

ACCESSORIES

02.6120 DMX Signal Amplifier / Isolator (Req'd for DMX signal splitting)
13.6203 - Top & side visor
13.6205 - 2" Egg-crate louver

