

SWAROVSKI

INNOVISIONS IN LIGHTING

Lighting systems modules & accessories



CONTENTS

Crystal StarLED

Modules for individual lighting design	3 – 10
Accessories	11 – 12

Crystal StarLED Deluxe

Modules for individual lighting design	13 – 14
Accessories	15 – 16

Optical-fibre lighting systems

Modules for individual lighting design	17 – 24
Prisms and prism spots	25 – 26
Lens systems and optic spots	27 – 28
Installation Accessories	29 – 31
Light guides	32 – 33
Light projectors	34
Accessories	35

Appendix

Pictograms	36
Protection classes	37 – 38

CRYSTAL
12 mm

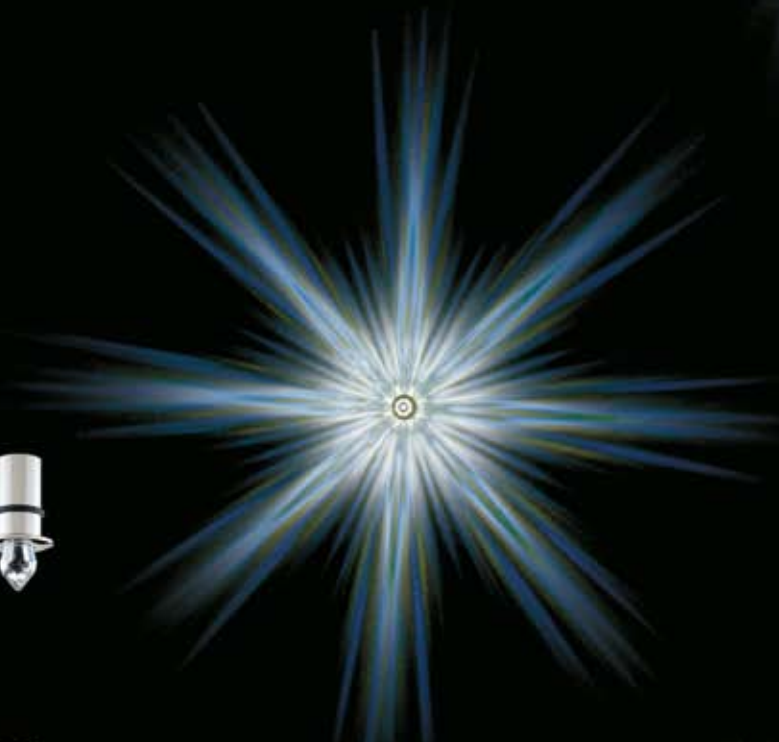

CRYSTAL
25 mm

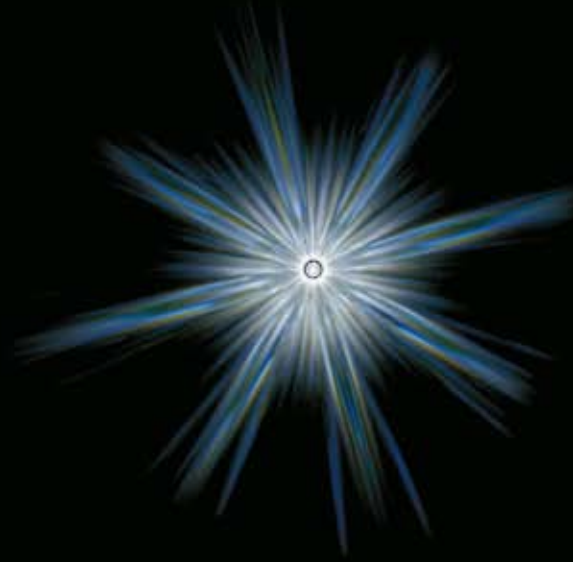

CRYSTAL
36 mm

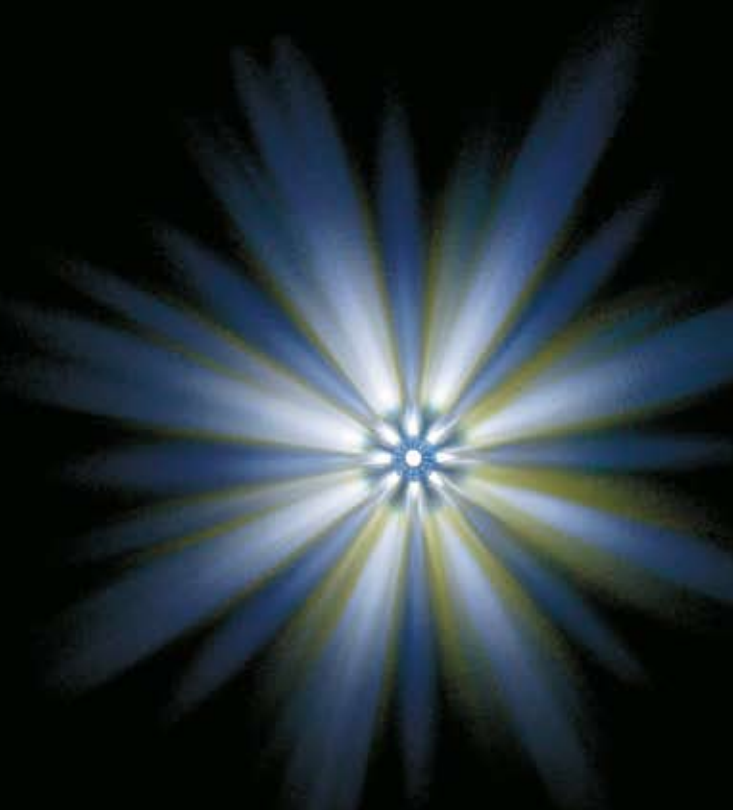

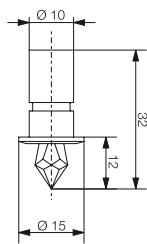

CRYSTAL 12 mm

Weight: 10.1 g

Product	Article number A.9945 NR ...	Version
CRYSTAL 12 mm	010 400	gold-plated
	010 402	nickel-plated

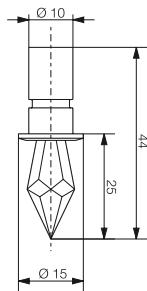

CRYSTAL 25 mm

Weight: 13.6 g

Product	Article number A.9945 NR ...	Version
CRYSTAL 25 mm	010 500	gold-plated
	010 502	nickel-plated

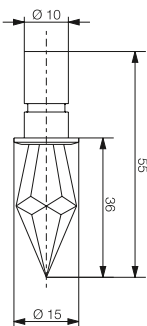

CRYSTAL 36 mm

Weight: 18.7 g

Product	Article number A.9945 NR ...	Version
CRYSTAL 36 mm	010 600	gold-plated
	010 602	nickel-plated

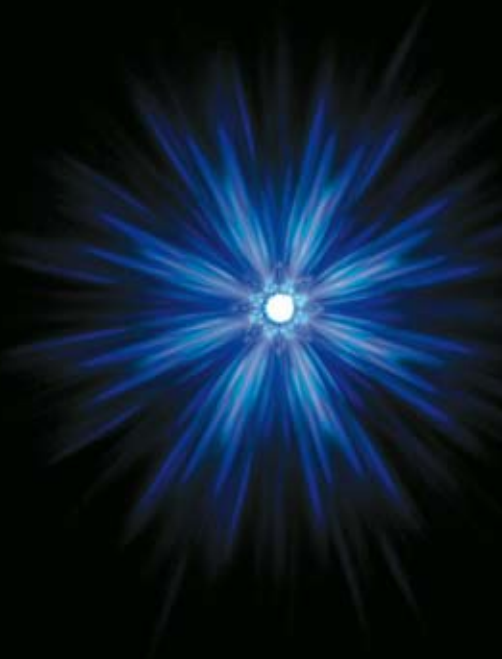

CRYSTAL 25 mm medium sapphire

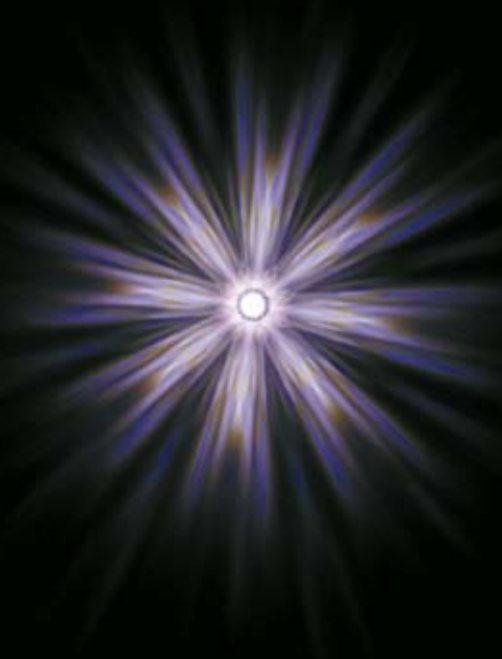

CRYSTAL 25 mm rosaline

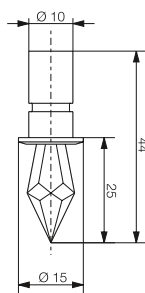

CRYSTAL 25 mm medium sapphire

Weight: 13.6 g

Product	Article number A.9945 NR ...	Version
CRYSTAL 25 mm medium sapphire	010 507 010 508	gold-plated nickel-plated

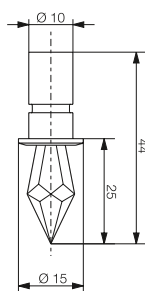

CRYSTAL 25 mm rosaline

Weight: 13.6 g

Product	Article number A.9945 NR ...	Version
CRYSTAL 25 mm rosaline	010 509 010 510	gold-plated nickel-plated

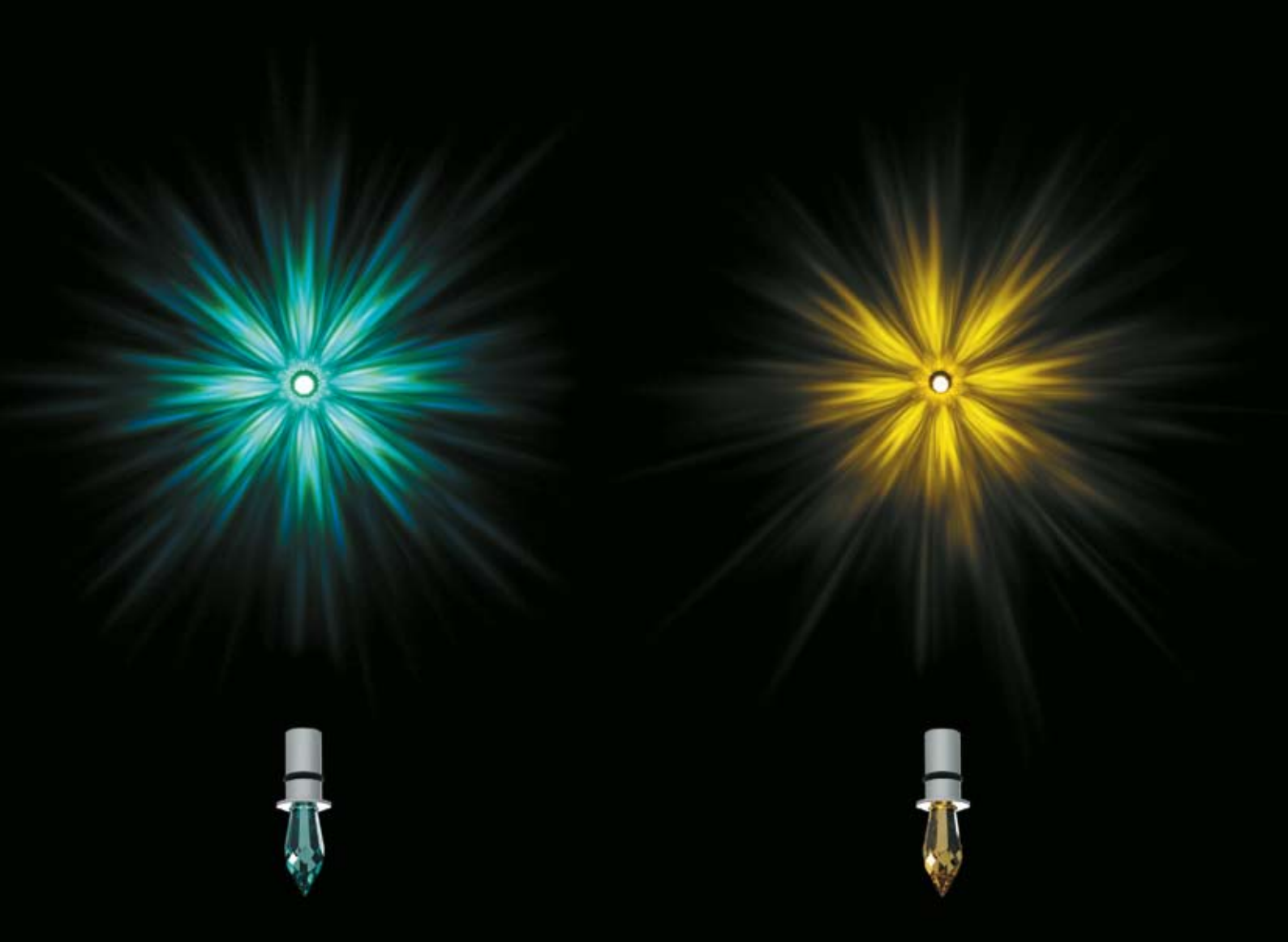

CRYSTAL 25 mm antique green

CRYSTAL 25 mm light topaz

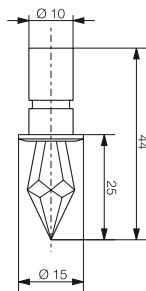

CRYSTAL 25 mm antique green

Weight: 13.6 g

Product	Article number A.9945 NR ...	Version
CRYSTAL 25 mm antique green	010 503 010 504	gold-plated nickel-plated

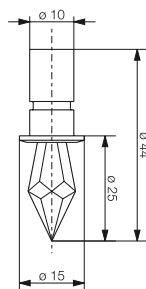

CRYSTAL 25 mm light topaz

Weight: 13.6 g

Product	Article number A.9945 NR ...	Version
CRYSTAL 25 mm light topaz	010 505 010 506	gold-plated nickel-plated

CRYSTAL
Ø 20 mm



CRYSTAL
Ø 31 mm

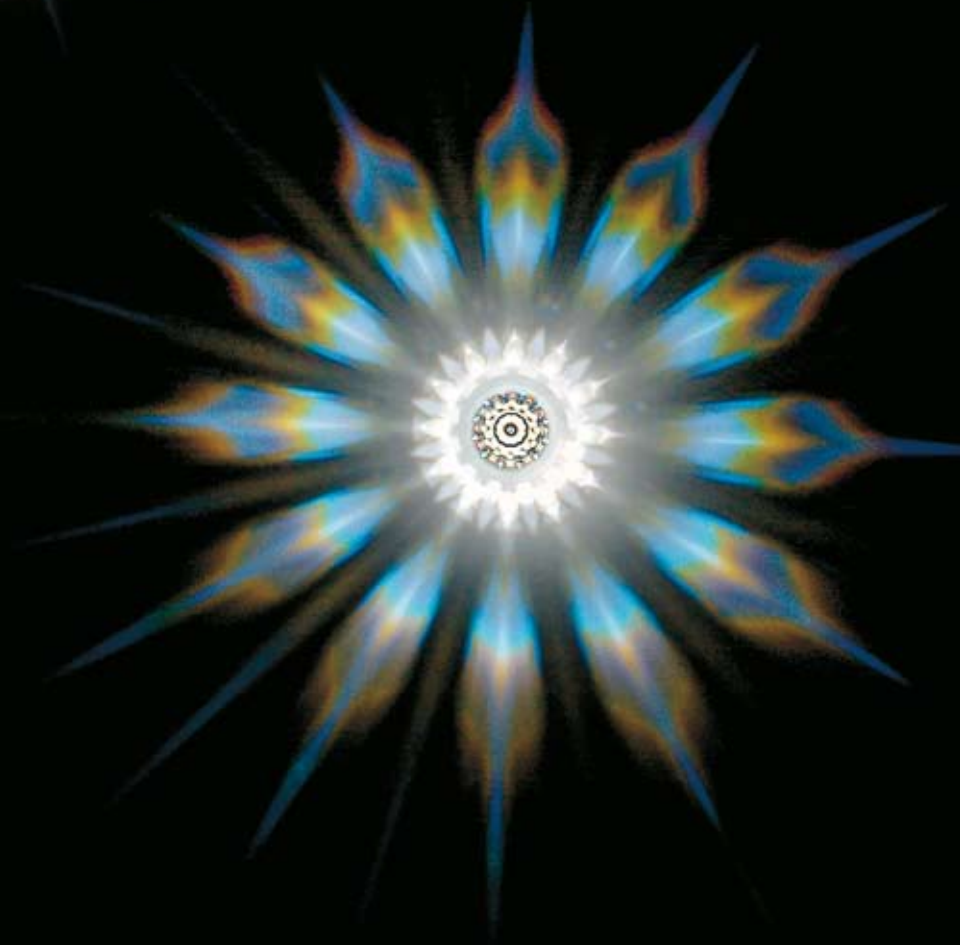

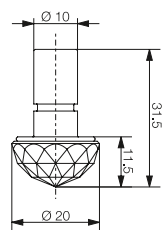

CRYSTAL Ø 20 mm

Weight: 13.9 g

Product	Article number A.9945 NR ...	Version
CRYSTAL Ø 20 mm	010 850	gold-plated
	010 852	nickel-plated

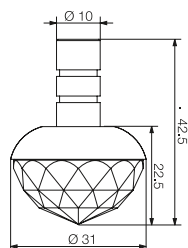

CRYSTAL Ø 31 mm

Weight: 51.7 g

Product	Article number A.9945 NR ...	Version
CRYSTAL Ø 31 mm	010 810	nickel-plated

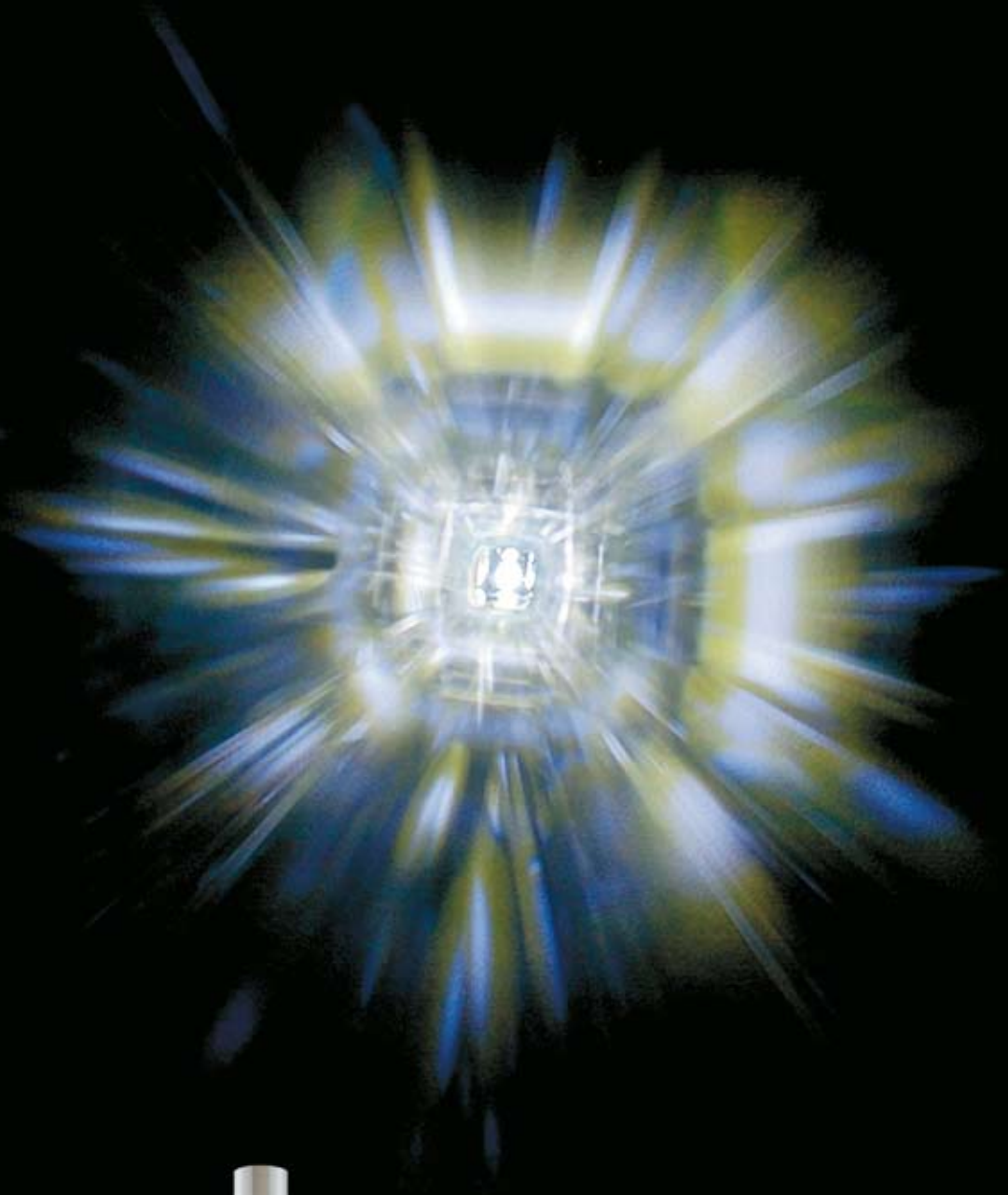

DOUBLE CUBE straight

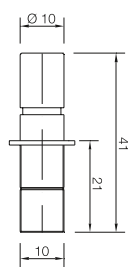

DOUBLE CUBE straight

Weight: 13.4 g

Product	Article number	Version
DOUBLE CUBE straight	A.9945 NR ...	nickel-plated
	015 303	

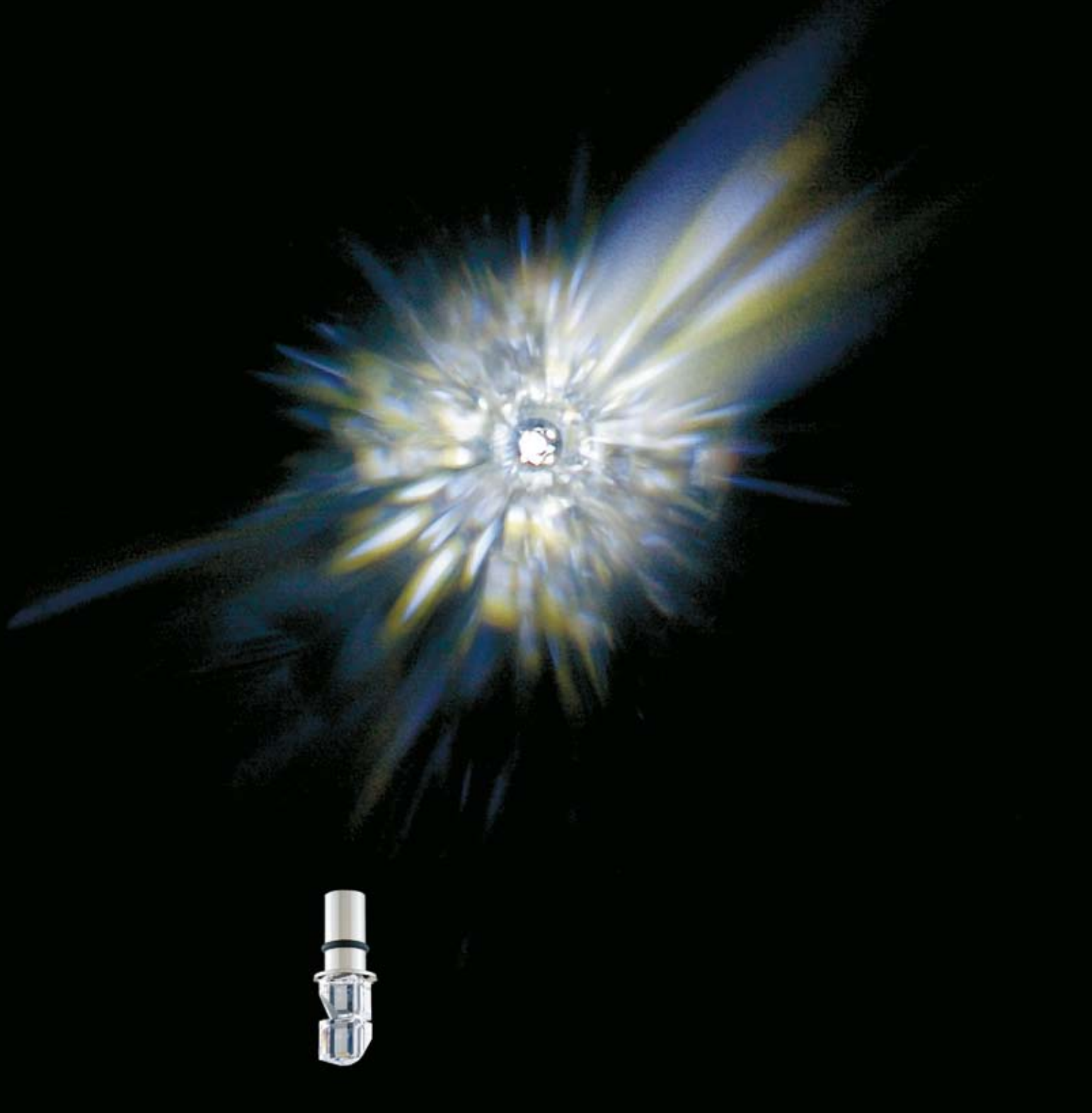

DOUBLE CUBE diagonal

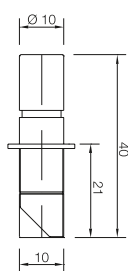

DOUBLE CUBE diagonal

Weight: 12.4 g

Product	Article number	Version
DOUBLE CUBE diagonal	A.9945 NR ...	nickel-plated
	015 403	

ACCESSORIES

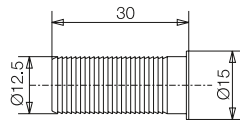
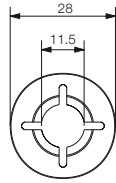

UNIVERSAL-MOUNTING SLEEVES transparent plastic

Suitable for all kinds of ceilings from 5 – 25 mm

Ceiling opening: 12.5 mm
Weight: 1.5 g

Product	Article number	Version
UNIVERSAL-MOUNTING SLEEVES	A.9945 NR ... 019 034	transparent

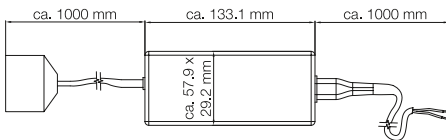

ELECTRONIC POWER SUPPLY UNIT with external plug-in connector block

Power supply unit with mains cable and fixed external connector-block for secondary connection of the distributor modules

Dimensions: 133.1 x 57.9 x 29.2 mm (L x W x H)
Weight: 350 g
Primary voltage: 100 – 240 V, 50/60 HZ
Secondary voltage: 6 V DC
Wattage: max. 42 W
Operating temperature: 0 – 40°C

6-way plug-in connector block, for connection of 6 distributor modules

Dimensions: 44 x 40.5 x 14.7 mm (L x W x H)
Length of mains cable to power supply unit: 1,000 mm

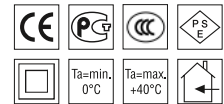

Product	Article number	Version
ELECTRONIC POWER SUPPLY UNIT	A.9943 NR ... 000 025	

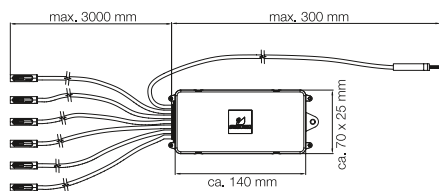

DISTRIBUTOR MODULE 0.5W

with integrated electronic safety fuses,
 1 cable (0.3 m) for connecting to plug-in connector block
 6 cables (3 m each) with one LED insert per cable

Distributor module: 140 x 70 x 25 mm (L x W x H)
 LED-Insert: 29 x 7.33 mm (L x Ø)
 Light colour: daylight white (ca. 8,000K)
 neutral white (ca. 3,500K)
 Weight: 580 g

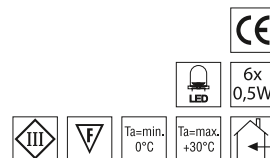

Product	Article number A.9943 NR ...	Light colour
DISTRIBUTOR MODULE 0.5 W	000 026 000 027	daylight white (ca. 8,000K) neutral white (ca. 3,500K)

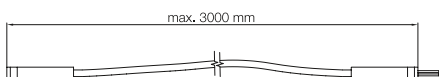

EXTENSION CABLE

incl. plug and socket for placement between plug-in connector block and distributor module

Length: 3 m
 Note: max. extension 15 m (5 extension cables 3 m each)
 Weight: 93 g

Product	Article number A.9943 NR ...	Version
EXTENSION CABLE	000 028	Length: 3 m

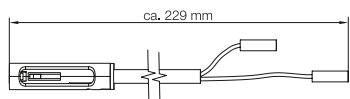

REPAIR-KIT 0.5 W

for quick and easy replacement of defective LED-inserts by authorised, trained staff.
 The kit contains 6 LED inserts each with 200 mm cable and spring sleeve.

Weight: 51 g



Product	Article number A.9943 NR ...	Light colour
REPAIR-KIT 0.5 W	000 029 000 030	daylight white (ca. 8,000K) neutral white (ca. 3,500K)

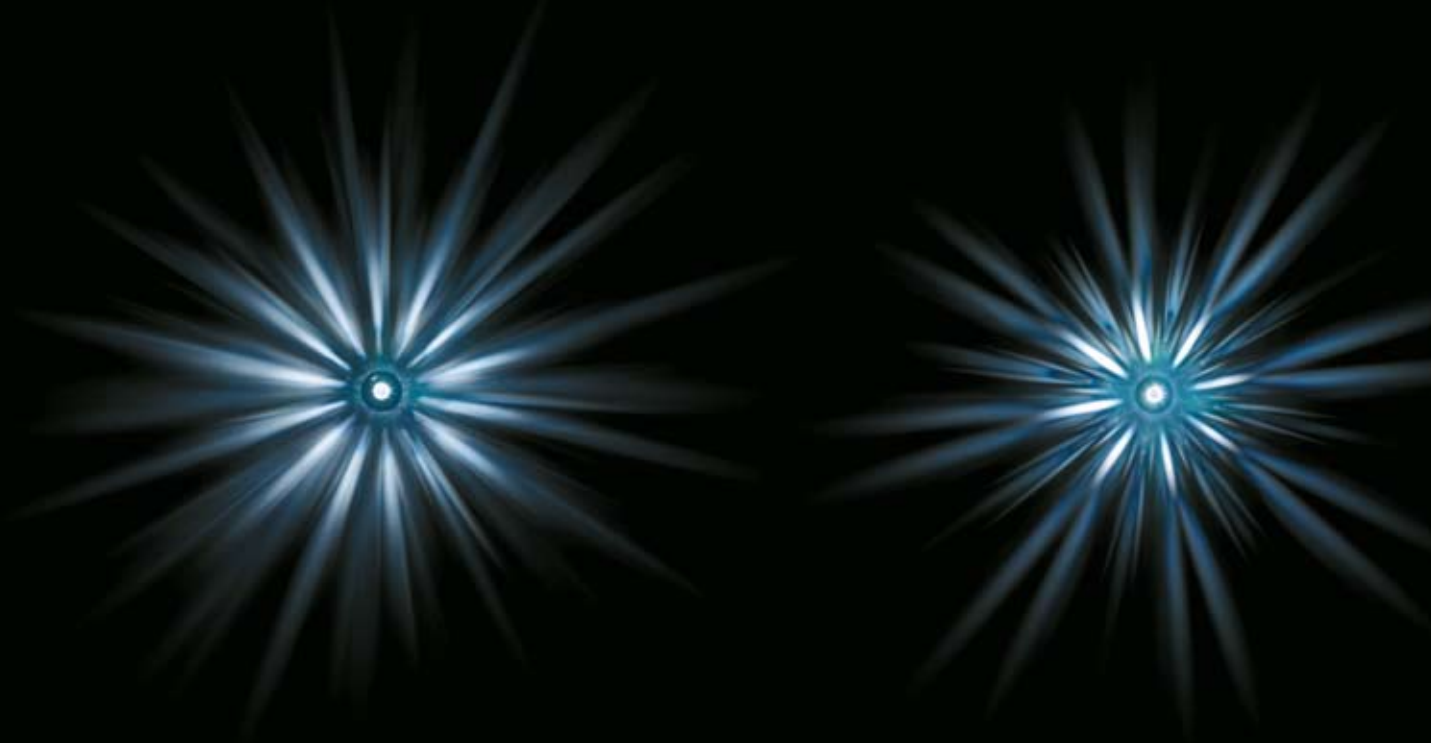

CRYSTAL 8¹⁴

CRYSTAL 8¹⁶

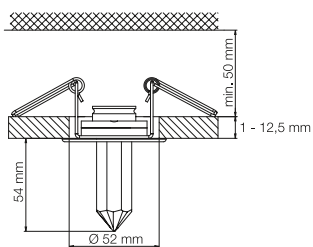

CRYSTAL 8¹⁴

Effect: attractive star pattern (diameter approx. 0.9 m)
 Weight: 190 g

Product	Article number A.9945 NR ...	Version
CRYSTAL 8 ¹⁴	000 031 000 032	gold-plated chrome-plated

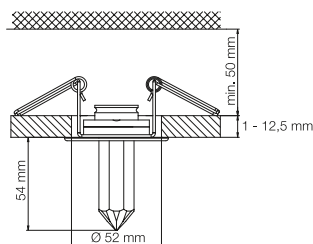

CRYSTAL 8¹⁶

Effect: attractive star pattern (diameter approx. 0.9 m)
 Weight: 190 g

Product	Article number A.9945 NR ...	Version
CRYSTAL 8 ¹⁶	000 033 000 034	gold-plated chrome-plated

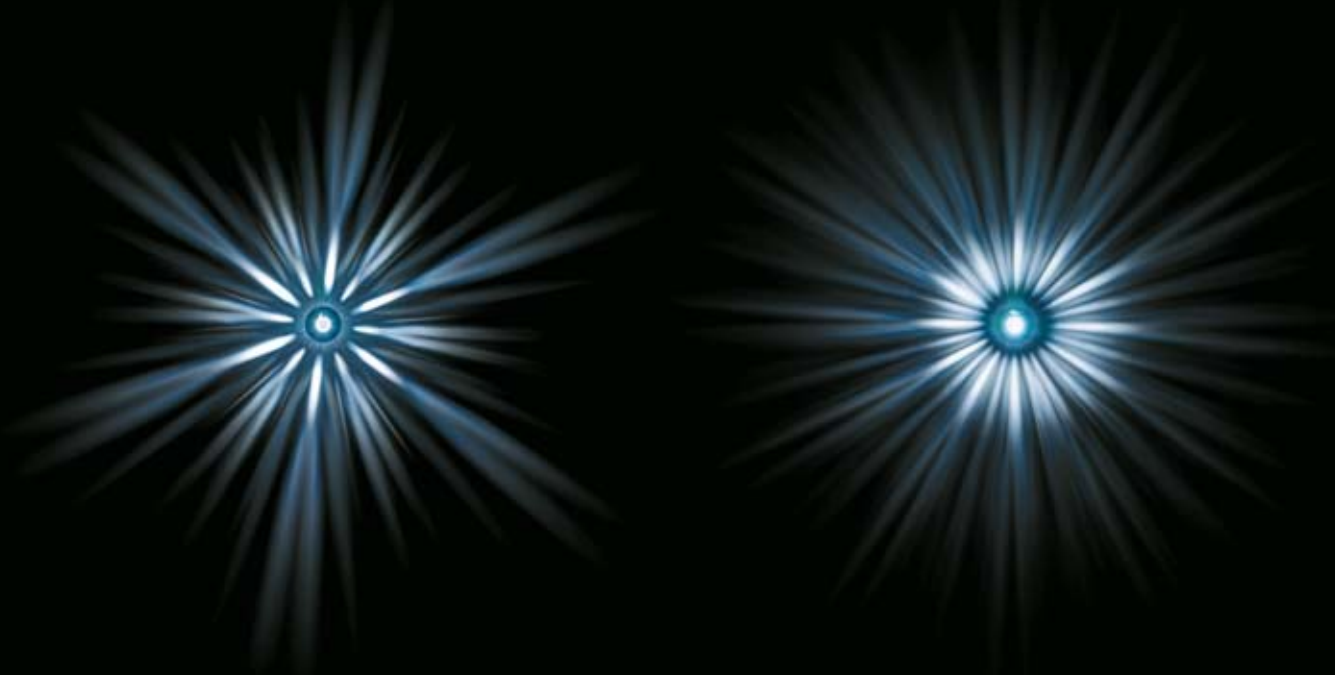

CRYSTAL 12¹²

CRYSTAL 12²⁴

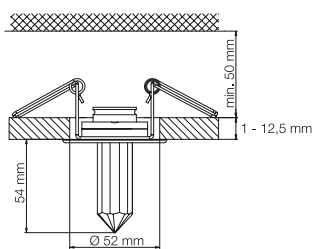

CRYSTAL 12¹²

Effect: attractive star pattern (diameter approx. 0.9 m)
 Weight: 190 g

Product	Article number A.9945 NR ...	Version
CRYSTAL 12 ¹²	000 038 000 039	gold-plated chrome-plated

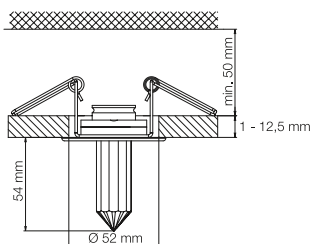

CRYSTAL 12²⁴

Effect: attractive star pattern (diameter approx. 0.9 m)
 Weight: 190 g

Product	Article number A.9945 NR ...	Version
CRYSTAL 12 ²⁴	000 040 000 041	gold-plated chrome-plated

ACCESSORIES

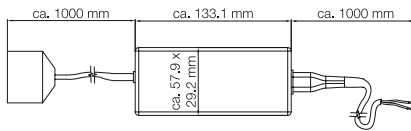

ELECTRONIC POWER SUPPLY UNIT with external plug-in connector block

Power supply unit with 1 m flying lead for mains connection and secondary socket for connecting a distribution module.

Dimensions: 133.1 x 57.9 x 29.2 mm (L x W x H)
 Weight: 350 g
 Primary voltage: 100 – 240 V, 50/60 HZ
 Secondary voltage: 6 V DC
 Wattage: max. 42 W
 Operating temperature: 0 – 40°C

6-way plug-in connector block for connection of 3 distribution modules.

Dimensions: 44 x 40.5 x 14.7 mm (L x W x H)
 Length of mains cable to power supply unit: 1,000 mm

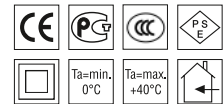

Product	Article number A.9943 NR ...	Version
ELECTRONIC POWER SUPPLY UNIT	000 025	

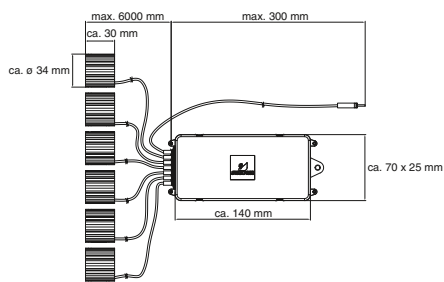

LED DISTRIBUTION MODULE 1 W

with integrated, electronic fuses, 1 cable (0.3 m) for connecting to plug-in connector block, 6 cables (each 6 m) each with an LED-insert

Distribution Module: 140 x 70 x 25 mm (L x W x H)
 LED-adapter: 1 W LED incl. heat sink,
 30 mm x Ø 34 mm
 Light colours: daylight white (ca. 6,700K),
 neutral white (ca. 3,400K)
 Weight: 1,340 g

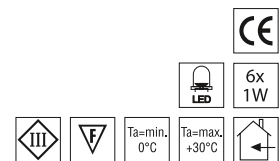

Product	Article number A.9943 NR ...	Light colour
LED DISTRIBUTION MODULE 1 W	000 033	daylight white (ca. 6,700K)
	000 034	neutral white (ca. 3,400K)

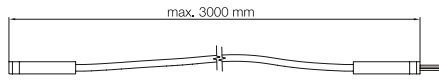

EXTENSION CABLE

incl. plug and socket for placement between plug-in connector block and distributor module

Length: 3 m
 Note: max. extension 15 m (5 extension cables 3 m each)
 Weight: 93 g

Product	Article number A.9943 NR ...	Version
EXTENSION CABLE	000 037	Length: 3 m

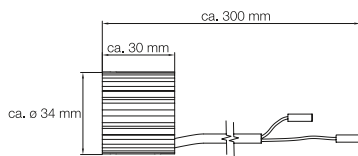

REPAIR-KIT 1 W

for quick and easy replacement of defective LED-inserts by authorised, trained staff.
 The kit contains 1 LED insert each with 270 mm cable and spring sleeve.

Weight: 58 g



Product	Article number A.9943 NR ...	Light colour
REPAIR-KIT 1 W	000 035	daylight white (ca. 6,700K)
	000 036	neutral white (ca. 3,400K)

SPHERICAL LENS
Ø 7.4 mm



CRYSTAL
12 mm



CRYSTAL
16.5 mm



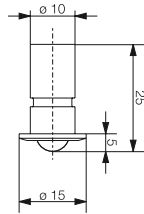

SPHERICAL LENS \varnothing 7.4 mm

Recommended glass fibre harness: Size 1.5 (\varnothing 1.4 mm)
 Effect: Decorative and functional light point (dispersion angle: $2 \times 12^\circ$)
 Weight: 10.2 g
 Use: Starry Sky, room, accent, sauna and shower lighting, etc.

Product	Article number A.9942 NR ...	Version
SPHERICAL LENS \varnothing 7.4 mm	010 300 010 302 010 305 010 307	gold-plated nickel-plated chrome matt white

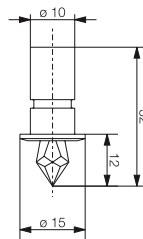

CRYSTAL 12 mm

Recommended glass fibre harness: Size 1.5 (\varnothing 1.4 mm)
 Effect: Star pattern on the ceiling
 Weight: 10.5 g
 Use: Starry Sky

Product	Article number A.9942 NR ...	Version
CRYSTAL 12 mm	010 400 010 402 010 400MC* 010 402MC* 010 405 010 407 010 405MC* 010 407MC*	gold-plated nickel-plated gold-plated nickel-plated chrome matt white chrome matt white

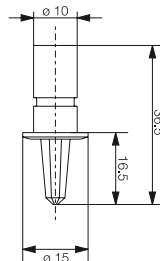

CRYSTAL 16.5 mm

Recommended glass fibre harness: Size 1.5 (\varnothing 1.4 mm)
 Effect: Star pattern on the ceiling
 Weight: 11.0 g
 Use: Starry Sky

Product	Article number A.9942 NR ...	Version
CRYSTAL 16.5 mm	010 900 010 902 010 900MC* 010 902MC* 010 905 010 907 010 905MC* 010 907MC*	gold-plated nickel-plated gold-plated nickel-plated chrome matt white chrome matt white

* MC: Multicolour-effect; star pattern multicoloured

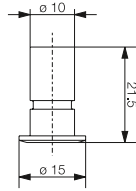

LIGHT POINT

For glass fibres Size 1.5, 3 (Ø 1.4, 2 mm)
 Effect: Light point
 Outlet: 2.5 mm
 Weight: 7.4 g
 Use: Starry Sky

Product	Article number A.9942 NR ...	Version
LIGHT POINT 2.5 mm	010 200	gold-plated
	010 202	nickel-plated
	010 204	chrome matt
	010 206	white

For glass fibres Size 8, 14 (Ø 3, 4 mm)
 Effect: Light point
 Outlet: 4.2 mm
 Weight: 7.4 g
 Use: Room, accent illumination

Product	Article number A.9942 NR ...	Version
LIGHT POINT 4.2 mm	010 250	gold-plated
	010 252	nickel-plated
	010 254	chrome matt
	010 256	white

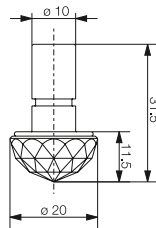

CRYSTAL Ø 20 mm

Recommended glass fibre harness: Size 1.5, 3, 8, 14 (Ø 1.4, 2, 3 and 4 mm)
 Effect: Decorative and functional light point (dispersion angle: 2 x 20°)
 Weight: 14.3 g
 Use: Starry Sky, room, accent, sauna and shower lighting, etc.

Product	Article number A.9942 NR ...	Version
CRYSTAL Ø 20 mm	010 850	gold-plated
	010 852	nickel-plated

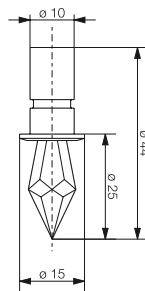

CRYSTAL 25 mm

Recommended glass fibre harness: Size 1.5 (Ø 1.4 mm)
 Effect: Star pattern on the ceiling
 Weight: 14.0 g
 Use: Starry Sky

Product	Article number A.9942 NR ...	Version
CRYSTAL 25 mm	010 500	gold-plated
	010 502	nickel-plated

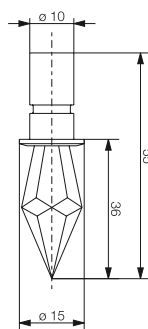

CRYSTAL 36 mm

Recommended glass fibre harness: Size 1.5 (Ø 1.4 mm)
 Effect: Star pattern on the ceiling
 Weight: 19.1 g
 Use: Starry Sky

Product	Article number A.9942 NR ...	Version
CRYSTAL 36 mm	010 600	gold-plated
	010 602	nickel-plated

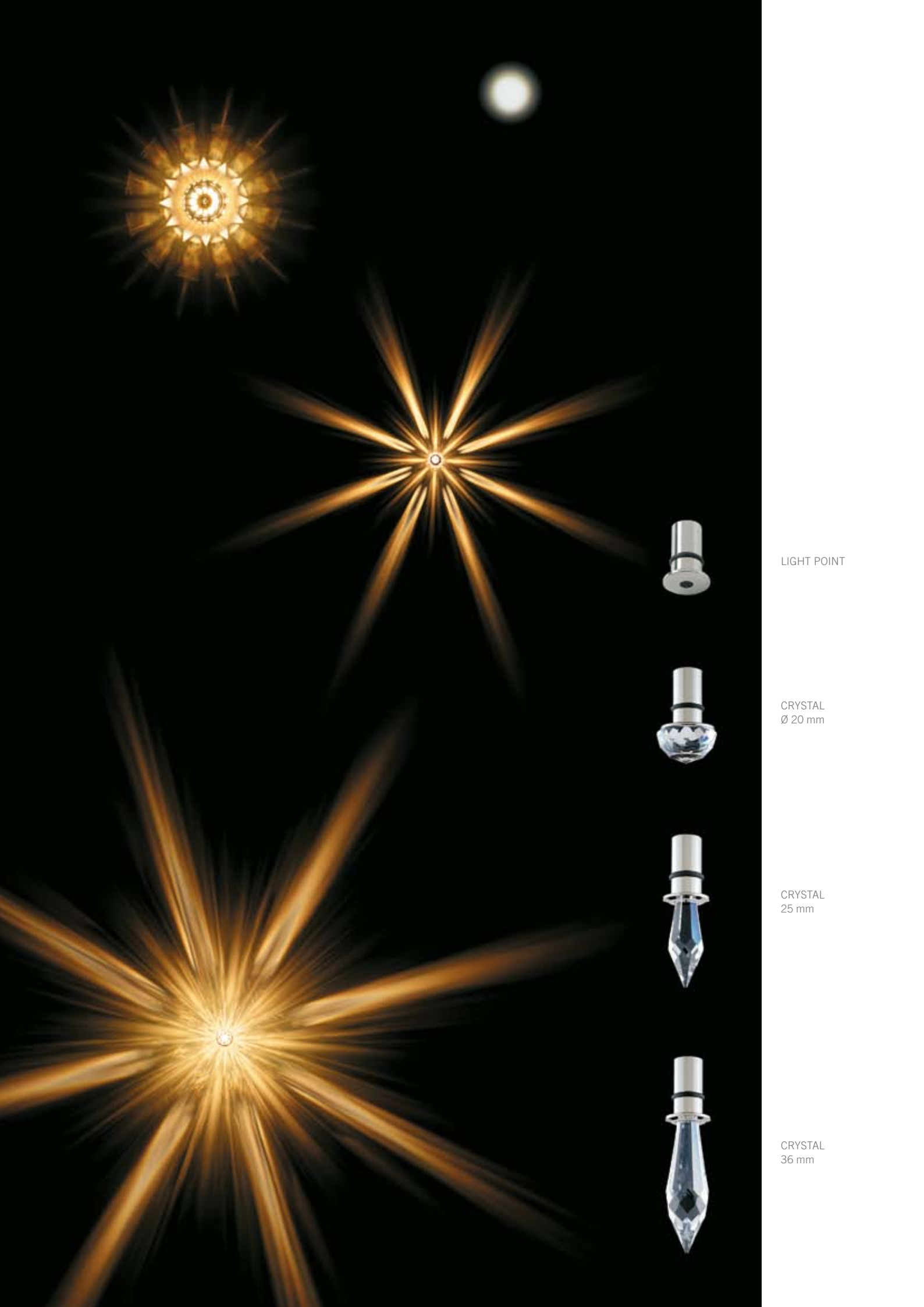

LIGHT POINT



CRYSTAL
Ø 20 mm



CRYSTAL
25 mm



CRYSTAL
36 mm



DOUBLE CUBE straight

DOUBLE CUBE diagonal

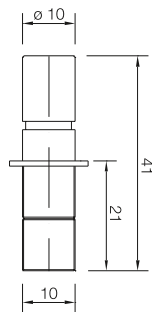

DOUBLE CUBE straight

Recommended glass fibre harness: Size 1.5 (Ø 1.4 mm)
 Effect: Linear, geometric reflection
 Weight: 13.8 g
 Use: Decorative light fitting for Graffiti

Product	Article number A.9942 NR ...	Version
DOUBLE CUBE straight	015 303 015 305 015 307	nickel-plated chrome matt white

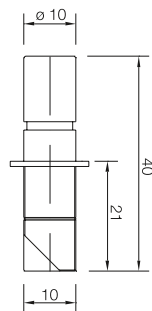

DOUBLE CUBE diagonal

Recommended glass fibre harness: Size 1.5 (Ø 1.4 mm)
 Effect: Contemporary picturesque reflection
 Weight: 12.8 g
 Use: Decorative light fitting for Graffiti

Product	Article number A.9942 NR ...	Version
DOUBLE CUBE diagonal	015 403 015 405 015 407 015 403MC* 015 405MC* 015 407MC*	nickel-plated chrome matt white nickel-plated chrome matt white

* MC: Multicolour-effect; Pattern multicoloured



ASHLAR



MINI WALL WASHER

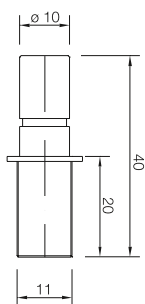

ASHLAR

Recommended glass fibre harness: Size 1.5 (Ø 1.4 mm)
 Effect: Geometric contemporary reflection
 Weight: 12.6 g
 Use: Decorative light fitting for Graffiti

Product	Article number A.9942 NR ...	Version
ASHLAR	015 503 015 505 015 507	nickel-plated chrome matt white

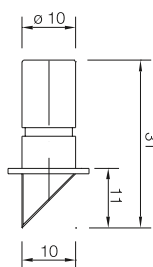

MINI WALL WASHER

Recommended glass fibre harness: Size 1.5 (Ø 1.4 mm)
 Effect: Geometric contemporary reflection
 Weight: 9.1 g
 Use: Accent illumination and decorative light fitting for Graffiti

Product	Article number A.9942 NR ...	Version
MINI WALL WASHER	015 603 015 605 015 607	nickel-plated chrome matt white

CRYSTAL
ø 31 mm



CRYSTAL SPOT
ø 31 mm



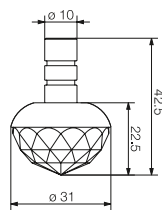

CRYSTAL Ø 31 mm

Glass fibre harness: Size 8 or 14 (Ø 3 or 4 mm)
 Effect: Decorative and functional light point
 Dispersion angle: Size 8: 2 x 12°
 Size 14: 2 x 15°
 Weight: 52.1 g
 Use: Room, accent lighting, etc.

Product	Article number A.9942 NR ...	Version
CRYSTAL Ø 31 mm	010 810	nickel-plated

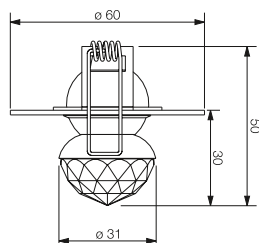

CRYSTAL SPOT Ø 31 mm

Glass fibre harness: Size 8 or 14 (Ø 3 oder 4 mm)
 Effect: Decorative and functional light point
 Dispersion angle: Size 8: 2 x 12°
 Size 14: 2 x 15°
 Swivelling range: 2 x 35° ball-and-socket joint
 Ceiling opening: 45 mm
 Note: Spring retainer suitable for all ceilings, except for mineral fibre ceilings and ceilings under 4 mm thickness.
 Weight: 167.5 g
 Use: Room, accent lighting, etc.

Product	Article number A.9942 NR ...	Version
CRYSTAL SPOT Ø 31 mm	010 820	nickel-plated

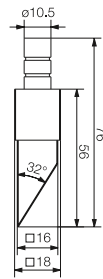

PRISM 32°

Glass fibre harness: Size 8 or 14 (Ø 3 or 4 mm)
 Effect: Decorative and functional deviating prism
 Dispersion angle: 2 x 13°
 Weight: 28.2 g
 Use: Wall and picture lighting, etc.

Product	Article number A.9942 NR ...	Version
PRISM 32°	011 400	nickel-plated

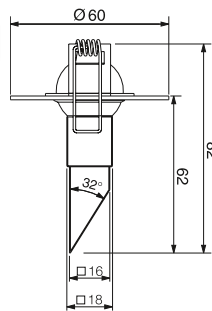

PRISM SPOT 32°

Glass fibre harness: Size 8 or 14 (Ø 3 or 4 mm)
 Effect: Decorative and functional deviating prism
 Dispersion angle: 2 x 13°
 Swivelling range: 2 x 35° ball-and-socket joint
 Ceiling opening: 45 mm
 Weight: 143.6 g
 Use: Wall and picture lighting etc.
 Note: Spring retainer suitable for all ceilings, except for mineral fibre ceilings and ceilings under 4 mm thickness.

Product	Article number A.9942 NR ...	Version
PRISM SPOT 32°	011 410	nickel-plated

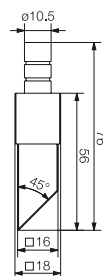

PRISM 45°

Glass fibre harness: Size 8 or 14 (Ø 3 or 4 mm)
 Effect: Decorative and functional deviating prism
 Dispersion angle: 2 x 13°
 Weight: 32.6 g
 Use: Wall and picture lighting.

Product	Article number A.9942 NR ...	Version
PRISM 45°	011 300	nickel-plated

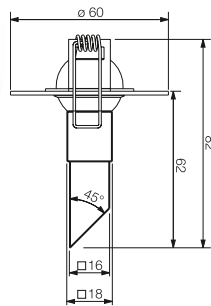

PRISM SPOT 45°

Glass fibre harness: Size 8 or 14 (Ø 3 or 4 mm)
 Effect: Decorative and functional deviating prism
 Dispersion angle: 2 x 13°
 Swivelling range: 2 x 35° ball-and-socket joint
 Ceiling opening: 45 mm
 Weight: 148.0 g
 Use: Wall and picture lighting, etc.
 Note: Spring retainer suitable for all ceilings, except for mineral fibre ceilings and ceilings under 4 mm thickness.

Product	Article number A.9942 NR ...	Version
PRISM SPOT 45°	011 310	nickel-plated

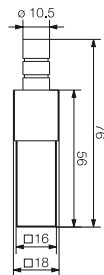

PRISM 0°

Glass fibre harness: Size 8 or 14 (Ø 3 or 4 mm)
 Effect: Decorative and functional light point
 Dispersion angle: 2 x 13°
 Weight: 38.4 g
 Use: Room, accent and zonal lighting, lighting of tables, desks, etc.

Product	Article number A.9942 NR ...	Version
PRISM 0°	011 200	nickel-plated

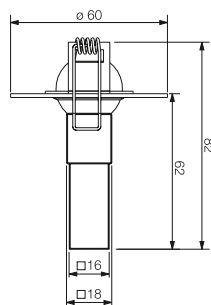

PRISM SPOT 0°

Glass fibre harness: Size 8 or 14 (Ø 3 or 4 mm)
 Effect: Decorative and functional light point
 Dispersion angle: 2 x 13°
 Swivelling range: 2 x 35° ball-and-socket joint
 Ceiling opening: 45 mm
 Weight: 153.8 g
 Use: General, accent and zonal lighting, task lighting of tables, desks, etc.
 Note: Spring retainer suitable for all ceilings, except for mineral board ceilings and ceilings with less than 4 mm thickness.

Product	Article number A.9942 NR ...	Version
PRISM SPOT 0°	011 210	nickel-plated

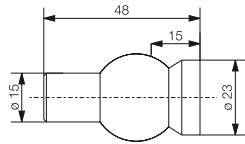

FOCUSING LENS SYSTEM

Glass fibre harness: Size 8, 14, 24, 36 (\varnothing 3, 4, 5.8 and 7.3 mm)
 Dispersion angle: Manually, infinitely adjustable from 2 x 10° to 2 x 29° (dependent on fibre size)
 Swivelling range: 2 x 35° ball-and-socket joint
 Note: Holder in aluminium rail or mounting ring.
 Weight: 28.4 g
 Use: Showcase and picture lighting, etc.
 Note: Adjustment key (A.9942 NR 051 003) for directing the lenses is available.

Product	Article number A.9942 NR ...	Version
FOCUSING	030 010	black
LENS SYSTEM	030 011	white
	030 012	nickel-plated

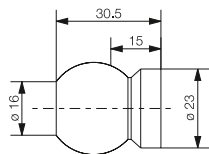

SPHERICAL LENS SYSTEM

Glass fibre harness: Size 3, 8, 14, 24, 36 (\varnothing 2, 3, 4, 5.8 and 7.3 mm)
 Dispersion angle: From 2 x 6° to 2 x 24° adjustable (dependent on fibre size)
 Swivelling range: 2 x 35° ball-and-socket joint
 Note: Holder in aluminium rail or mounting ring.
 Weight: 26.0 g
 Use: Showcase and picture lighting, etc.
 Note: Adjustment key (A.9942 NR 051 003) for aiming the lenses is available.

Product	Article number A.9942 NR ...	Version
SPHERICAL	030 110	black
LENS SYSTEM	030 111	white
	030 112	nickel-plated

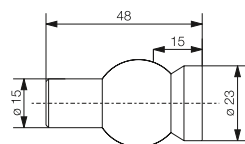

AUXILIARY LENS SYSTEM

Glass fibre harness: exclusively for Size 8 or 14 (\varnothing 3 or 4 mm)
 Beam angle: From 2 x 4° to 2 x 10° adjustable (depending on fibre size)
 Swivelling range: 2 x 35° ball-and-socket joint
 Note: Holder in aluminium rail or mounting ring.
 Weight: 24.0 g
 Use: Showcase lighting, according to principle of mirror reflection.
 Hinweis: Adjustment key (A.9942 NR 051 003) for directing the lenses is available.

Product	Article number A.9942 NR ...	Version
AUXILIARY	030 210	black
LENS SYSTEM	030 211	white
	030 212	nickel-plated

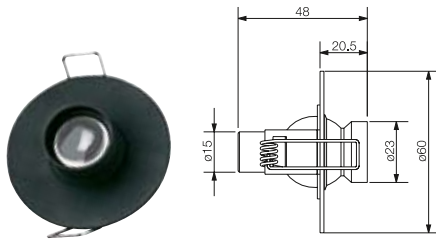

FOCUSING OPTIC SPOT

Glass fibre harness: Size 8, 14, 24, 36 (Ø 3, 4, 5.8 und 7.3 mm)
 Dispersion angle: Manually, infinitely adjustable from 2 x 10° to 2 x 29° (depending on fibre size)
 Swivelling range: 2 x 35° ball-and-socket joint
 Ceiling opening: 45 mm
 Note: Spring retainer suitable for all ceilings, except for mineral fibre ceilings and ceilings with less than 4 mm thickness.
 Weight: 69.6 g
 Use: General, accent, zonal, picture and showcase lighting, etc.
 Notes: Adjustment key (A.9942 NR 051 003) for directing the lenses is available.

Product	Article number A.9942 NR ...	Version
FOCUSING OPTIC SPOT	020 810	white
	020 811	black
	020 813	nickel-plated

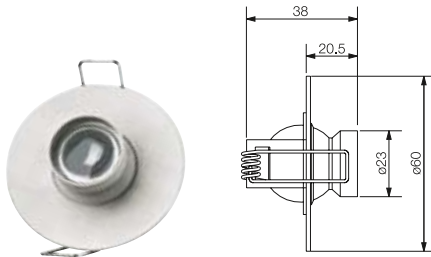

SPHERICAL OPTIC SPOT

Glass fibre harness: Size 3, 8, 14, 24, 36 (Ø 2, 3, 4, 5.8 and 7.3 mm)
 Dispersion angle: 2 x 6° - 2 x 24° adjustable (depending on fibre size)
 Swivelling range: 2 x 35° ball-and-socket joint
 Ceiling opening: 45 mm
 Note: Spring retainer suitable for all ceilings, except for mineral fibre ceilings and ceilings less than 4 mm thick.
 Weight: 65.5 g
 Use: General, accent, zonal, picture and showcase lighting, etc.

Product	Article number A.9942 NR ...	Version
SPHERICAL OPTIC SPOT	020 800	white
	020 801	black
	020 803	nickel-plated

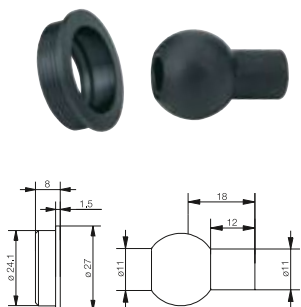

MINI-LENS (incl. mounting ring)

Glass fibre harness: Size 3, 8, 14 (Ø 2, 3, 4 mm)
 Dispersion angle: 2 x 16° - 2 x 26° (dependent on fibre size)
 Swivelling range: 2 x 35°
 Ceiling opening: 24 mm
 Note: Retainer in mounting ring only for wooden- or plaster board ceilings. Adjustment key (A.9967 NR 230 837) for aiming the lenses is available. Short end ferrules for Size 8 and 14 on request. (crimb ferrules)
 Weight: 12 g
 Use: General, accent, zonal, picture and showcase lighting, etc.

Product	Article number A.9942 NR ...	Version
MINI-LENS	020 700	white, mounting ring white
	020 701	black, mounting ring black
	020 703	chrom, mounting ring translucent

MOUNTING SLEEVES

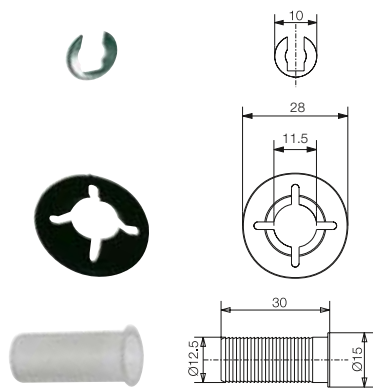

UNIVERSAL MOUNTING SLEEVE transparent plastic

Suitable for all light fittings and for all kinds of ceilings.
Temperature resistant up to 60° C.

Ceiling opening: 12.5 mm
Use: Optimal for Starry Sky, showers, swimming pools.
Weight: 1.5 g

Product	Article number A.9942 NR ...	Version
UNIVERSAL MOUNTING SLEEVE	019 034	transparent plastic

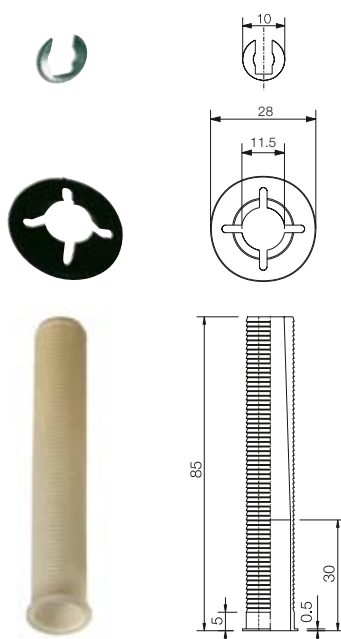

UNIVERSAL MOUNTING SLEEVE 85 mm

Suitable for all light fittings. Temperature resistant up to 110° C.

Ceiling opening: 13 mm
Use: Perfect for use in saunas, steam baths and for ceilings more than 25 mm thick
Weight: 4.2 g

Product	Article number A.9942 NR ...	Version
UNIVERSAL MOUNTING SLEEVE 85 mm	019 039	white plastic

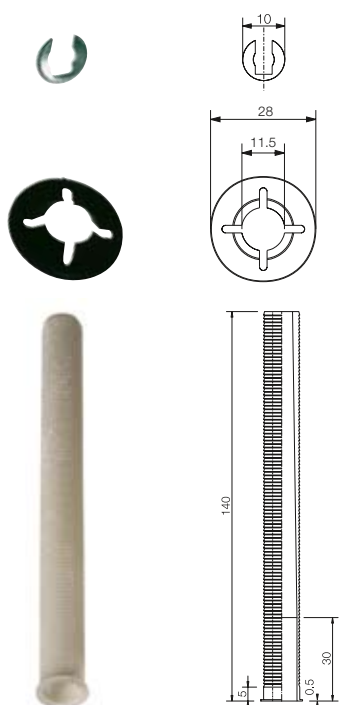

UNIVERSAL MOUNTING SLEEVE 140 mm

Suitable for all light fittings. Temperature resistant up to 110° C.

Ceiling opening: 13 mm
Use: Perfect for use in saunas, steam baths and for ceilings more than 25 mm thick.
Weight: 7.6 g

Product	Article number A.9942 NR ...	Version
UNIVERSAL MOUNTING SLEEVE 140 mm	019 036	white plastic

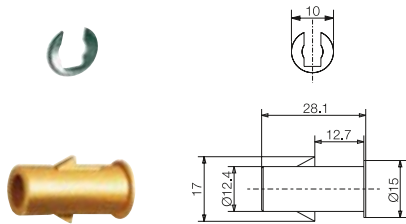

MOUNTING SLEEVE gold-coloured plastic

Suitable for all light fittings (except A.9942 NR 010 810).

Ceiling opening: 12.5 mm
 Only for: Plasterboard ceilings of min. thickness 12.5 mm.
 Use: Optimal for Starry Skies, showers, swimming pools.
 Weight: 0.9 g

Product	Article number A.9942 NR ...	Version
MOUNTING SLEEVE	019 031	gold-coloured plastic

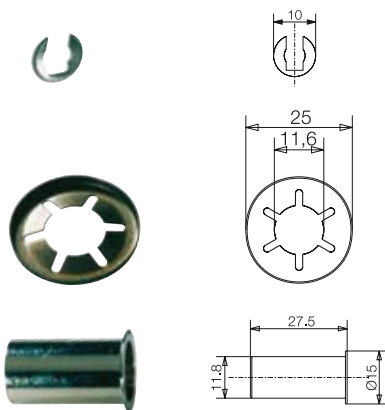

MOUNTING SLEEVE gold-plated metal

Suitable for all light fittings and for all kinds of ceilings.

Ceiling opening: 12 mm
 Use: Optimal for saunas, lift cabins, prisms
 and for glass fibre harnesses, Size 8 and larger.
 Weight: 6.0 g

Product	Article number A.9942 NR ...	Version
MOUNTING SLEEVE	019 030	gold-plated metal

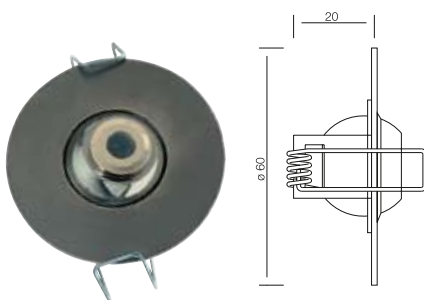

SPHERICAL JOINT nickel-plated

Spring retainer for functional and decorative light fittings.

Ceiling opening: 45 mm
 Tiltable range: 2 x 35°
 Weight: 115.4 g
 Note: Illustration with spherical lens A.9942 NR 010 302.

Product	Article number A.9942 NR ...	Version
SPHERICAL JOINT	019 041	nickel-plated

MOUNTING ACCESSORIES

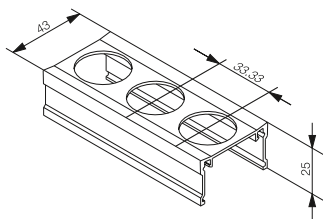

ALUMINIUM RAIL

Holder for focusing-, spherical- and auxiliary lens systems. Max. 30 lenses per running meter. Any open holes closed with black plastic inserts. Rail cut to length as required.

Product	Article number A.9942 NR ...	Version
ALUMINIUM RAIL	030 300	black

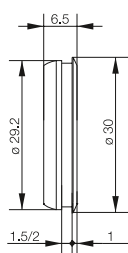

MOUNTING RING

Holder for focusing-, spherical- and auxiliary lens systems.

Diameter: 29 mm

Note: Suitable only for material with a thickness of 1.5 mm or 2.0 mm.

Product	Article number A.9942 NR ...	Version
MOUNTING RING	030 350	Material thickness 1.5 mm, black
	030 352	Material thickness 1.5 mm, transparent
	030 354	Material thickness 1.5 mm, white
	030 351	Material thickness 2.0 mm, black
	030 353	Material thickness 2.0 mm, transparent
	030 355	Material thickness 2.0 mm, white

LIGHT GUIDES

Glass fibre light guides consist of a common end and a number of individual tails with optical diameters from 1 to 7.3 mm. Depending on this diameter, up to 465 tails can be packed into a single fibre harness. In addition, glass fibre harnesses from Size 3/4 to Size 3 come with two spare tails.

CHARACTERISTICS:

- High transmission
- Outstanding colour characteristics
- Compliance with European fire prevention standards
- Electrical safety
- No maintenance required
- Unlimited life (no degeneration or aging)
- Transmission length up to 10 m
- Operating temperature -20 to +80°C
- Fine randomisation possible

GLASS FIBERS - NUMBER OF FIBRE TAILS

Fibre type (Size)	Size 3/4 ∅ 1 mm	Size 1 1/2 ∅ 1.4 mm	Size 3 ∅ 2 mm	Size 8 ∅ 3 mm	Size 14 ∅ 4 mm	Size 24 ∅ 5.8 mm	Size 36 ∅ 7.3 mm
max. number of tails	465	265	130	59	34	16	10
min. number of tails	58	32	15	7	4	2	2
fine randomisation recommendable	—	—	—	yes	yes	yes	yes

TECHNICAL DATA OF GLASS FIBRE TAILS

Fibre type (Size)	Optical-∅ (mm) (single tail)	Outside-∅ (mm) (single tail)	End sleeve-∅ (mm) (single tail) *	Smallest permissible bending radius (mm) **
Size 3/4	1.0	2.20 ± 0.10	3	5
Size 1 1/2	1.4	2.70 ± 0.10	3.5	8
Size 3	2.0	3.85 ± 0.15	5	15
Size 8	3.0	4.85 ± 0.15	5	20
Size 14	4.0	6.35 ± 0.15	5	25
Size 24	5.8	8.70 ± 0.30	8	50
Size 36	7.3	10.10 ± 0.30	8	60

RESIDUAL LIGHT VALUES (depending on tail length)

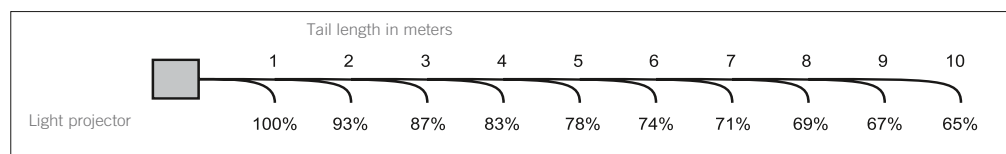

* All decorative and functional light fittings are adjusted to these end ferrule diameters. Drawings of all available end ferrules - see mounting instructions.

** With fibre lengths over 500 mm.

LIGHT GUIDES, endlight glass fibres, stock fibres

The glass fibre light guides listed here are available ex stock and can be delivered on short notice.
Individual light guides, also with different tail lengths and / or different fibre diameters are available upon request.

Art. No A.9942 NR ...	Size	Fibre Ø (mm)	Tails total	Tails single	Tail length (mm)	Weight (g)
110 122	$\frac{3}{4}$	Ø 1.0	80		5,000	3,020
115 010	$1\frac{1}{2}$	Ø 1.4	35	20 15	2,000 3,500	1,380
115 100	$1\frac{1}{2}$	Ø 1.4	60		2,000	1,580
115 110	$1\frac{1}{2}$	Ø 1.4	60		4,000	2,880
115 120	$1\frac{1}{2}$	Ø 1.4	70		3,000	2,600
115 119	$1\frac{1}{2}$	Ø 1.4	70	30 40	4,000 6,000	3,980
115 121	$1\frac{1}{2}$	Ø 1.4	80		3,000	2,740
115 122	$1\frac{1}{2}$	Ø 1.4	80		5,000	4,400
115 130	$1\frac{1}{2}$	Ø 1.4	100		3,000	3,350
115 150	$1\frac{1}{2}$	Ø 1.4	100	40 60	3,000 5,000	4,600
115 151	$1\frac{1}{2}$	Ø 1.4	100		8,000	8,550
115 140	$1\frac{1}{2}$	Ø 1.4	150		5,000	8,000
115 141	$1\frac{1}{2}$	Ø 1.4	150	60 60 30	5,000 8,000 10,000	11,150
120 110	3	Ø 2.0	80		3,000	5,600
130 100	8	Ø 3.0	40		2,000	3,260
140 091	14	Ø 4.0 fine randomised fibres	12		1,500	1,520
140 092	14	Ø 4.0 fine randomised fibres	12	6 6	3,500 6,000	3,720
140 100	14	Ø 4.0	20		1,200	1,920
140 104	14	Ø 4.0 fine randomised fibres	20	8 12	2,500 4,000	4,450
140 112	14	Ø 4.0 fine randomised fibres	24		2,000	3,450
140 130	14	Ø 4.0 fine randomised fibres	32	15 17	2,500 4,000	6,850
140 120	14	Ø 4.0 fine randomised fibres	33	20 13	2,000 3,000	5,850
140 121 with B4 end ferrules - only for mini-lenses	14	Ø 4.0 fine randomised fibres	33	20 13	2,000 3,000	5,100
140 140 with B4 end ferrules - only for mini-lenses	14	Ø 4.0 fine randomised fibres	32	15 17	3,000 5,000	8,200

LIGHT PROJECTORS

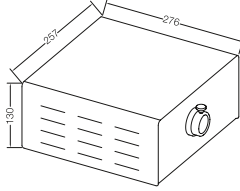

HIGH-LUX 100 W HALOGEN

Light projectors for optical-fibre lighting with integrated electronic transformer, quiet fan and Swarovski cold light glass reflector for optimal light efficiency; easy servicing through LampQuickChange; no use of UV/IR filters necessary. Simple and quick add-on possible with colour module, effect module. Mains cable for specific countries is available (see Accessories page 64)

Dimensions: 276 x 257 x 130 mm (LxWxH)
 Supply voltage: 230 – 240 V, 50 – 60 Hz
 Weight: 4,870 g
 Note: Light projector prepared to be connected to the electrical circuit using primary power cable.

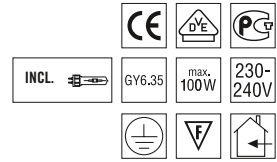

Product	Article number A.9943 NR ...	Version
HIGH-LUX 100 W halogen	500 100	with integrated electronic transformer

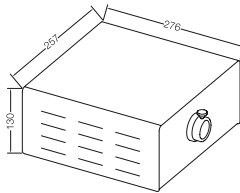

HIGH-LUX 70 W HID

Light projector for optical-fibre lighting with integrated electronic lamp ballast, quiet fan and Swarovski cold light glass reflector for optimal light efficiency; integrated diagnostic system for fault detection; easy servicing through LampQuickChange; no use of UV/IR filters necessary. Simple and quick add-on possible with colour module, effect module. Connecting cable for specific countries is available (see Accessories page 64)

Dimensions: 276 x 257 x 130 mm (LxWxH)
 Supply voltage: 220 – 240 V, 50 – 60 Hz
 Weight: 5,140 g
 Note: Light projector prepared to be connected to the electrical circuit using primary power cable.

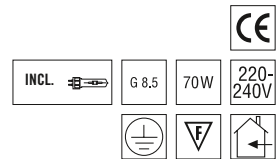

Product	Article number A.9943 NR ...	Version
HIGH-LUX 70 W HID	500 070	with integrated electronic lamp ballast

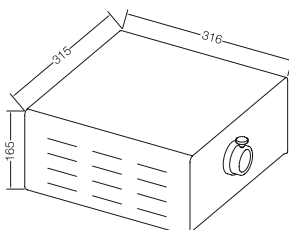

HIGH-LUX 150 W HID

Light projector for optical-fibre lighting with integral electronic lamp ballast, quiet fan and Swarovski cold light glass reflector for optimal light efficiency; integrated diagnostic system for fault detection; easy servicing through LampQuickChange; no use of UV/IR filters necessary. Simple and quick add-on possible with colour module, effect module. Connecting cable for specific countries is available (see Accessories page 64)

Dimensions: 316 x 315 x 165 mm (LxWxH)
 Weight: 8,580 g
 Supply voltage: 220 – 240 V, 50 – 60 Hz
 Note: Light projector prepared to be connected to the electrical circuit using primary power cable.

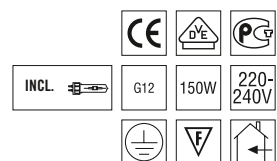

Product	Article number A.9943 NR ...	Version
HIGH-LUX 150 W HID	500 150	with integrated electronic lamp ballast

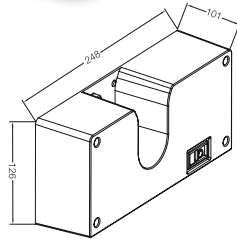

COLOUR MODULE FOR HIGH-LUX LIGHT PROJECTORS

Eight colours (yellow, red, green, blue, magenta, cyan, pink and white); continuous colour change; variable rotation speed (controller for speed adjustment available on light projector); connecting socket for an external switch for stop/start operation.

Weight: 850 g



Product	Article number A.9943 NR ...	Version
COLOUR MODULE	500 001	8 colours, continuous colour change

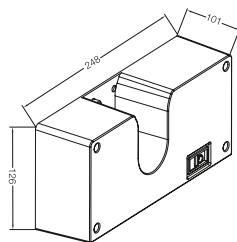

EFFECT MODULE FOR HIGH-LUX LIGHT PROJECTORS

The rotating effect wheel causes an irregular supply of light in the light guide which leads to alternating illumination and darkening of individual light points (flicker effect). Continuous rotation with variable adjustable rotation speed (speed controller on light projector); connecting socket for an external switch for stop/start operation.

Weight: 850 g



Product	Article number A.9943 NR ...	Version
EFFECT MODULE	500 004	flicker effect

ACCESSORIES Light projectors

Product	Article number A.9942 NR ...	Version
Lamp for High-Lux 100 W Halogen	059 112	100 W / 12 V, GY6.35
High-Lux 150 W HID	059 113	BLV HID 150 W, 4,200K, G12
	059 114	BLV HID 150 W, 3,000K, G12

Product	Article number A.9943 NR ...	Version
Lamp for High-Lux 70 W HID	500 003	CDM TC 70 W, 3,000K, G8.5
High-Lux 150 W HID	000 015	CDM SA/T 150 W, 4,200K, G12
Colour module for High-Lux Light Projectors	500 001	Colour module
Effect module for High-Lux Light Projectors	500 004	Effect module
Connection cable for High-Lux Light Projectors, EU	000 503	Length: 2 m
High-Lux Light Projectors, UK	000 507	Length: 2 m
High-Lux Light Projectors, CH	000 506	Length: 2 m

EXPLANATION OF THE PICTOGRAMS



The CE certification mark ("Certified Europe" or "Communauté Européenne") is proof of conformity with the "fundamental specifications" of relevant European standards.



Gost R: Certification of goods for export to the Russian Confederation relate to compliance with stipulations passed which guarantee safety to life, health and property of the consumer as well as environmental protection in Russia.



For electronic items including products covered by the German devices and product safety law (GPSG). The VDE mark denotes conformity with the VDE specifications or European or internationally harmonised standards and confirms compliance with the safety requirements of the appropriate directives. The VDE mark denotes the safety of the product in respect of electrical, mechanical, thermal, toxic, radiological and other risks.



The CCC text mark (CCC = China Compulsory Certification) is a compulsory test mark indicating the safety and quality of products sold on the Chinese market.



ENEC (European Norms Electrical Certification) European is a common certification mark for lamps and electrical components as provided for under the LUM agreement. It indicates norm conformity on products marked with European safety standards, in particular EN60598.



The PSE test symbol is a mandatory certification for Japan under the law of electrical appliances and material safety (DENAN).



Low voltage halogen lamp



IP 20 - IP 68: possible protection classes according to IEC 527. See table of IP protection classes



Low voltage halogen reflector lamp with cold-light mirror coating



Light fittings with this mark are only suitable for direct contact with non-combustible surfaces.



High voltage halogen reflector lamp with cold-light mirror coating



Light fittings with this mark can be mounted directly to normal flame resistant building materials without additional provisions.



Metal halide lamp



Light fittings with this mark can be mounted in or on normally-flammable surfaces with the use of heat insulation material.



LED lamp



Low-pressure lamp – suitable for use on lights without a protective cover.



Protection class I light fitting: connection of PE conductor required



max. power



Lamps, Class II protection: Due to appropriate insulation, the lamp has no tangible metal elements, which could lead to accidental electric shock. Not fitted with protective conductor.



Minimum distance to the lit object: 0.5 m



Protection class III light fitting: operation with safety extra-low voltage (SELV), creating a safety isolating transformer according to EN 61558-2-6.



Minimum / maximum ambient temperature



Connection voltage



Installation only in dry rooms



CONSUMER NOTICE: This Swarovski product is subject Directive 2002/96/EC of the European Parliament and the Council of the European Union on waste electrical and electronic equipment (WEEE) and is put on the market after August 13, 2005, and should not be disposed of as unsorted municipal waste. Please utilize your local WEEE collection facilities in the disposition of this product and otherwise observe all applicable legal requirements.



The luminaires/lighting systems in this catalogue are designed and manufactured in compliance with the specifications of EN 60598/VDE 0711. The largest part of the luminaires/lighting systems bears a corresponding test mark on the rating plate and on packaging and instructions for use. The other luminaires/lighting systems have been submitted for testing. The testing and approval procedure has not however yet been completed. Information on the current progress of approval marking can be obtained from us at any time.

IP PROTECTION

Unless specified otherwise, all luminaires and lighting systems comply with Protection Class IP20 (protected against solid foreign bodies greater than 12 mm, no protection from water and moisture).

IP PROTECTION CLASS AFTER THE FIRST NUMBER

First number	Short description	Brief list of details concerning foreign matter that cannot penetrate the enclosure
0	Without protection	No special protection
1	Protected against solid bodies greater than 50 mm	Large body surface, for instance a hand (but without protection against intentional contact); solid bodies
2	Protected against solid bodies greater than 12 mm	Fingers or similar up to a length of 80 mm; solid bodies with a diameter greater than 12 mm
3	Protected against solid bodies greater than 2.5 mm	Tools, wires etc. with a diameter or thickness greater than 2.5 mm; solid bodies with a diameter greater than 2.5 mm
4	Protected against solid bodies greater than 1 mm	Wires or strips thicker than 1 mm solid bodies with a diameter greater than 1 mm
5	Dust-protected	Ingress of dust is not totally prevented, but it is limited to a quantity that does not impair the proper function of the device
6	Dust-protected	No ingress of dust

IP PROTECTION

IP PROTECTION CLASS AFTER THE SECOND NUMBER

Second number	Short description	Details about the protection provided by the enclosure
0	Without protection	No special protection
1	Protection against dripping water	No deterioration as a result of dripping water (vertically falling drops)
2	Protection against dripping water with less than 15° tilting angle	No deterioration as a result of vertically falling drops if the enclosure is tilted from its prescribed position of normal use, subject to a maximum tilting angle of 15°.
3	Protected against spray-water	No deterioration as a result of spraying water subject to a maximum angle of 60° against the perpendicular
4	Protected against splashing water	No deterioration if water is sprayed with a nozzle from any direction against the enclosure
5	Protected against water jets	No deterioration if water is sprayed with a nozzle from any direction against the enclosure
6	Protected against heavy seas	Enclosure will not suffer an ingress of a harmful amount of water from heavy sea or water from a high pressure jet .
7	Protection against the effects of immersion	An ingress of a harmful amount of water is prevented if the enclosure is immersed in water at given conditions with regard to pressure and duration
8	Protection against the effects of continuous submersion	Device is suitable for continuous submersion in water (conditions to be stated by the manufacturer). Note: Under normal circumstances, this means that the device is totally sealed. However, with regard to some devices, it may mean that water does enter, but does not cause any damage.