

# HSF type

HSF 055  
 HSF 085  
 HSF 115  
 HSF 175

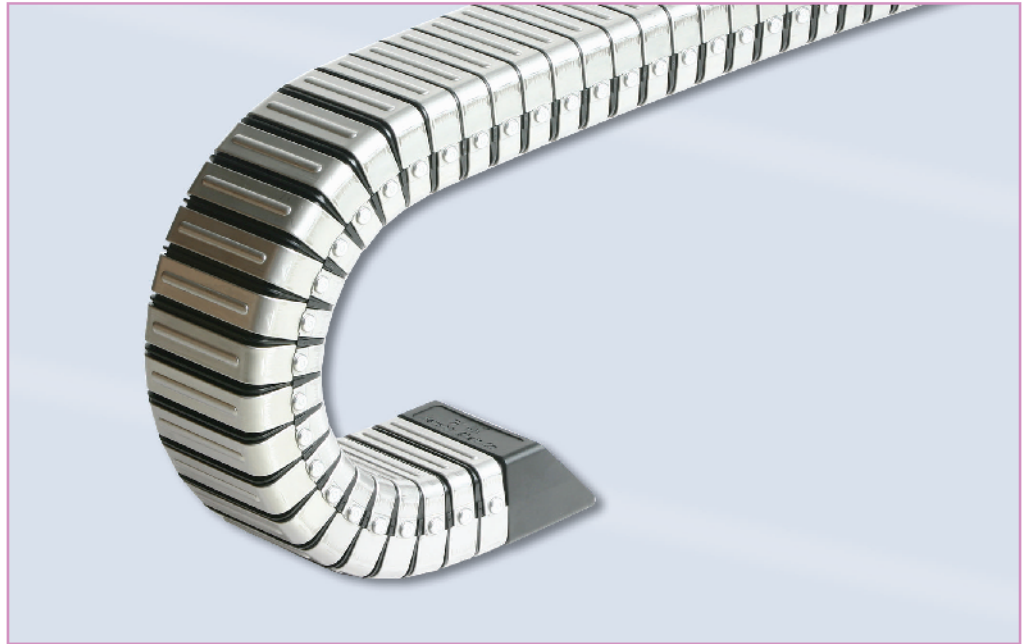

· 실용신안등록 제 079296호

## ● 용도 Application

공작기계, 산업용기계, 목공기계, 산업용로봇 등 CNC 기계에 적용.

*Applicable for CNC machines used in Machining center, Industrial robot, Wood work machine and so forth.*

## ● 특징 Features

- 닥트형이기 때문에 먼지 등 이물질이 들어가지 못하므로 Cable, Hose를 완전히 보호합니다.
- 스테인레스 스틸이기 때문에 외관이 미려합니다.
- 안쪽은 엔지니어링 플라스틱으로 절연체입니다.
- 부분 보수가 가능합니다.
- 12종의 다양한 모델이 구비되어 있습니다.

- *Best protection from dust and residual substances.*
- *Stainless steel structure gives good appearances.*
- *Engineering plastic is used in inside structure to provide insulation.*
- *Partial maintenance is possible.*
- *12 different model are manufactured.*

## ● 운용환경 Operation

HSF Type의 RoboChain는 외부로부터 먼지나 이물질의 침투를 막아 케이블이나 호스를 보호하도록 설계 제작되어 있습니다.

한편 Lock Pin을 이용하여 길이 조정 및 보수를 쉽게하실 수 있습니다.

HSF Type은 Cable, Hose의 사용을 허용면적의 70% 이내에 설계하여 주십시오.

*Duct structure of HSF prevents cable and hose from dust and residuals.*

*Easy adjustment and maintenance is possible using lock pin.*

*In particular, system designer should pay attention for cable and hose area not to exceed 70% of allowable area.*

## ● 주요제원 Properties

- 운동속도: 90m/min 이하
  - 케이블 호스의 직경: 60mm 이하
  - 사용온도: -25 ~ 100°C
  - 기본색: 은백색
  - 재질: Stainless Steel, 엔지니어링 플라스틱
- Moving Velocity: below 90m/min
  - Diameter of Cable Hose: less than 60mm
  - Operating Temperature: -25 ~ 100°C
  - Basic Color: Silver White
  - Material: Stainless steel, Engineering plastic

## ● 구조와명칭 Structure

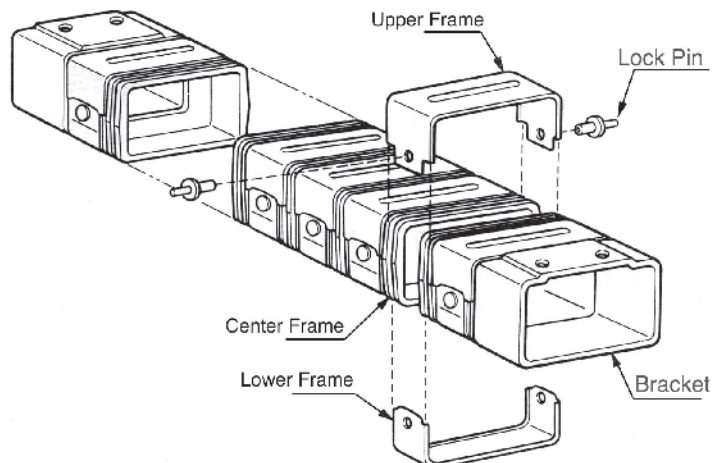

# HSF 055

Order Example (주문예)

HSF055	100R	1500L	3SETS
Type	Radius	Length	Q'ty

Chain, Brackets, Guide Rail

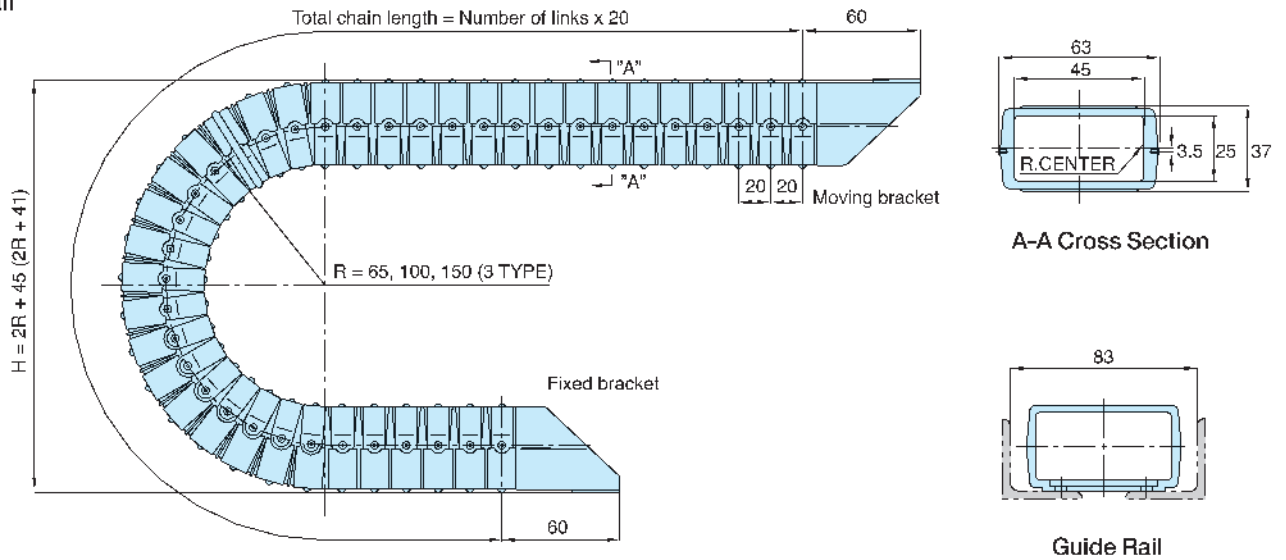

# HSF 085

Order Example (주문예)

HSF085	250R	2000L	3SETS
Type	Radius	Length	Q'ty

Chain, Brackets, Guide Rail

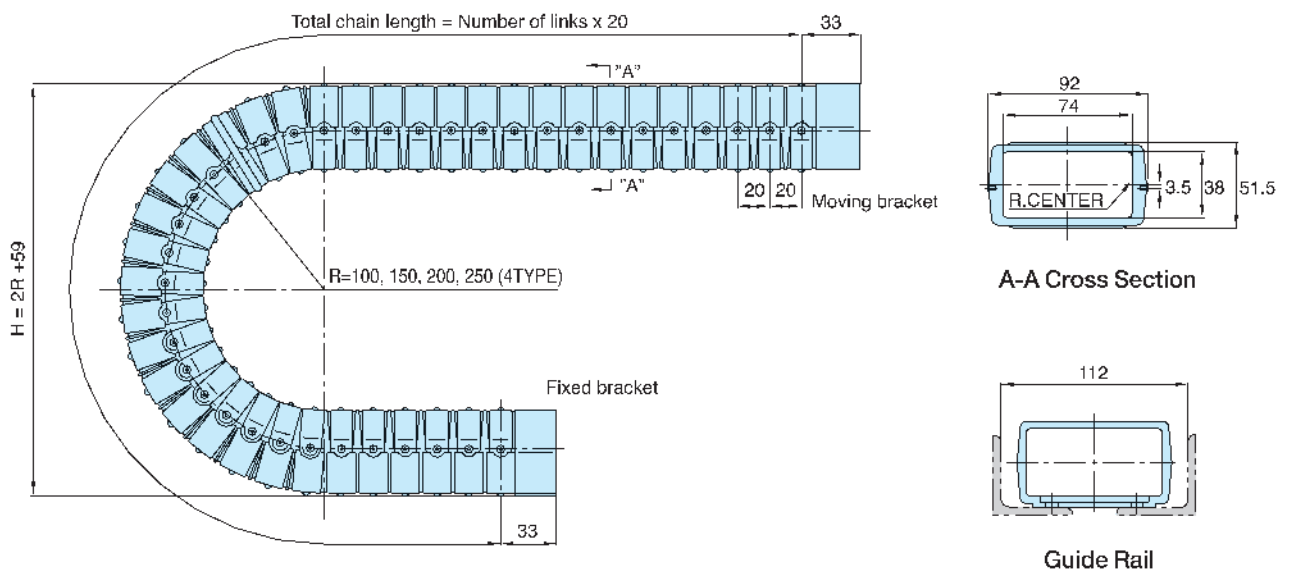

# HSF 115

Order Example (주문예)

HSF115	300R	2500L	3SETS
Type	Radius	Length	Q'ty

Chain, Brackets, Guide Rail

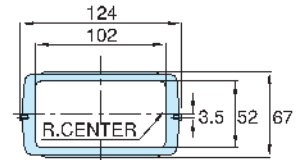
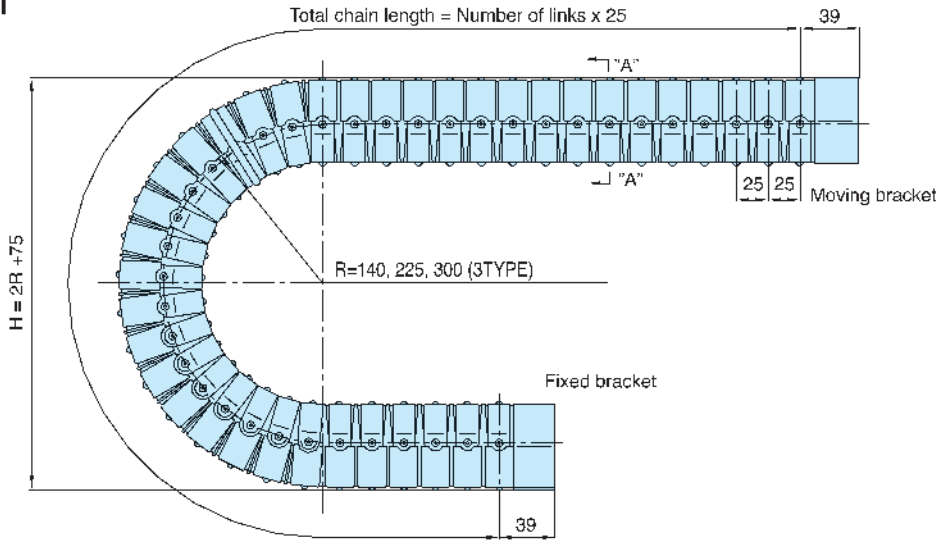

A-A Cross Section

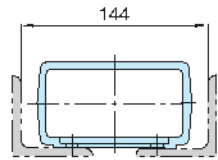

Guide Rail

# HSF 175

Order Example (주문예)

HSF175	250R	2750L	3SETS
Type	Radius	Length	Q'ty

Chain, Brackets, Guide Rail

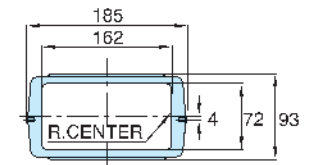
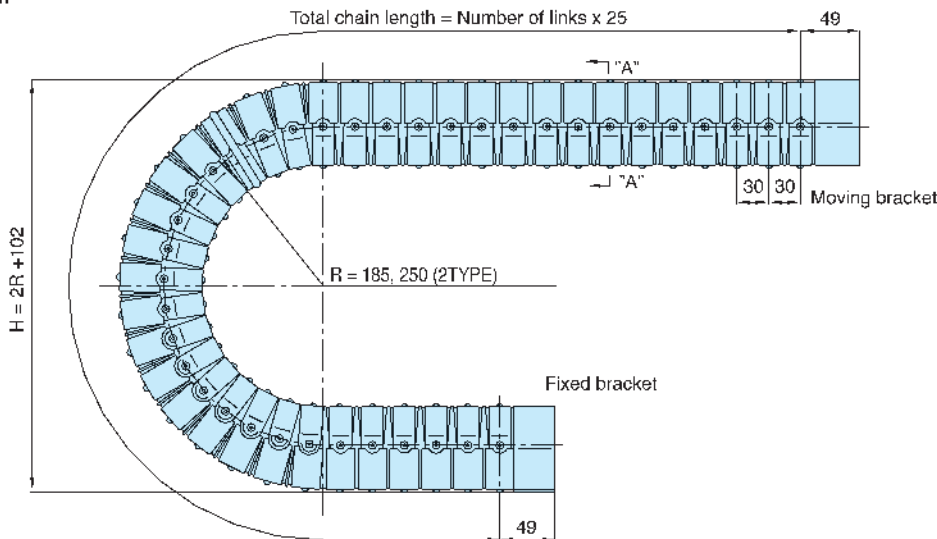

A-A Cross Section

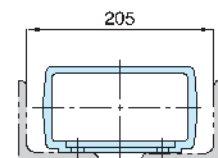

Guide Rail

## ● Bracket의 종류 Bracket

### A Type Only

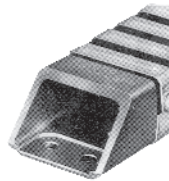
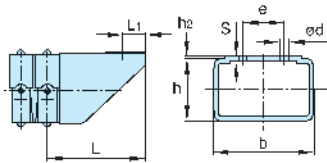

Type	b	h	h2	d	e	L	L1	S
HSF055	55.5	34	2	7	22	60	12.5	4.5
HSF085	84.3	52	5.5	7	35	75	17	5.5
HSF115	117.8	63	4	9	49	96	25	6
HSF175	181	90	9	11	95	110	25	9

### A Type

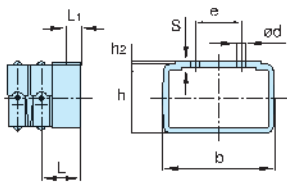

Type	b	h	h2	d	e	L	L1	S
HSF055								
HSF085	85	48.5	2	7	50	33	10	3.5
HSF115	117.5	63	2.5	9	65	39	10	3.5
HSF175	181	88	3	11	100	49	14	5.5

### B Type

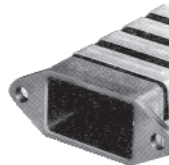
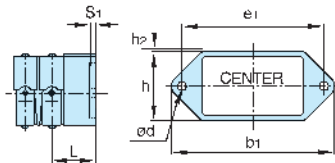



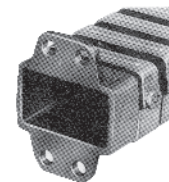
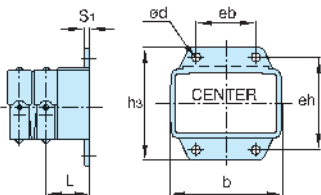

Type	b1	h	h2	d	e1	L	S1
HSF055	90	34	0	7	75	29.5	4
HSF085	123	48.5	2	7	107	37	6
HSF115	165	63	2.5	9	146	44	6
HSF175	231	88	3	11	205	55	8

### C Type

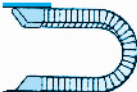
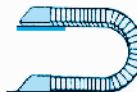
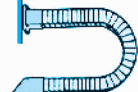
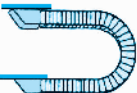
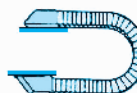

Type	b	h3	d	eb	eh	L	S1
HSF055	55.5	70	7	18	55	29.5	4
HSF085	85	85	7	45	70	37	6
HSF115	117.5	110	9	60	90	44	6
HSF175	181	144	11	95	118	55	8

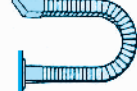
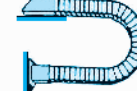
## ● Bracket의 연결 Attachment of Bracket

1		2		3	
4		5		6	
7		8		9	

● 능력선도 (HSF) Capability Graph

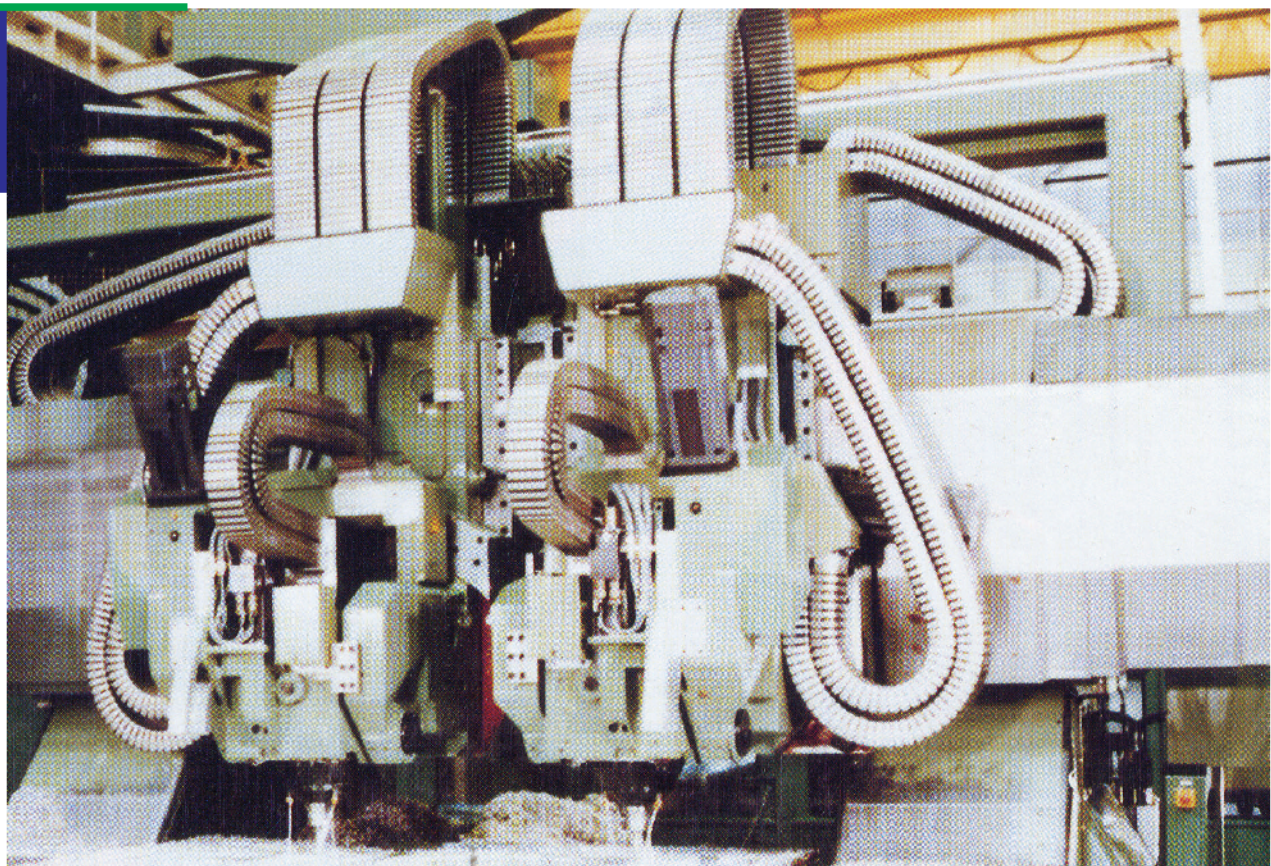
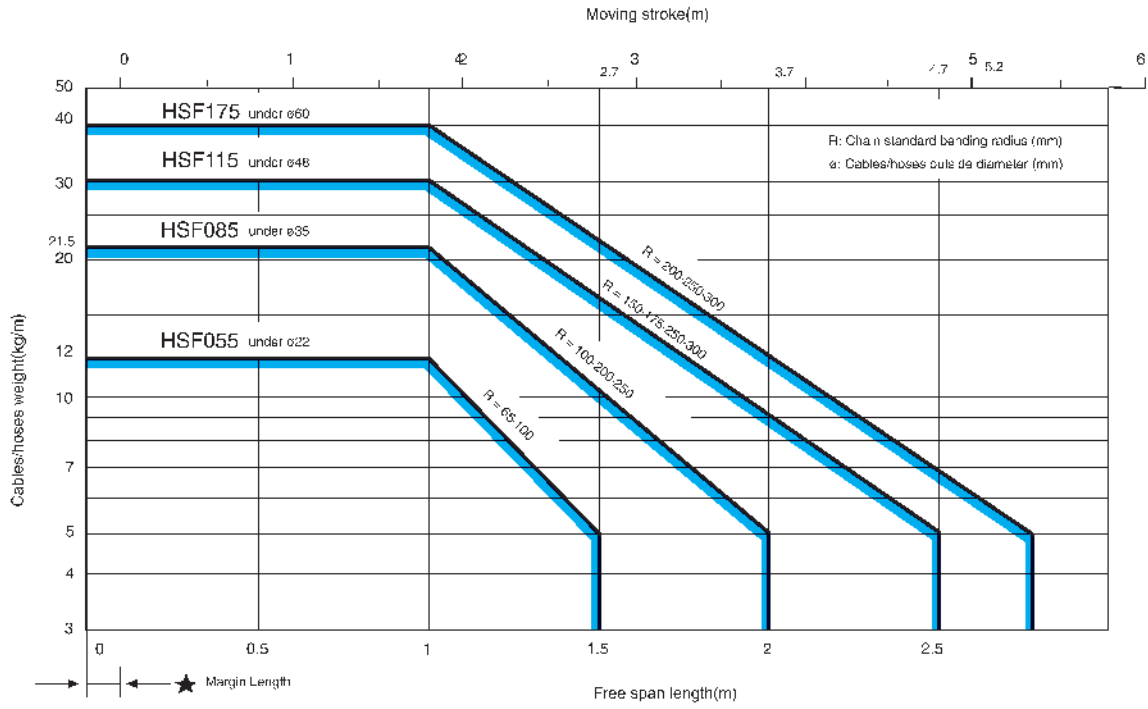

HSF