

*In order to achieve the highest-quality images possible, Cognex® offers a wide variety of light modules. The LED array light module is designed for use in typical bar light applications, including front, angle, and multiple-angle lighting (for feature highlighting). The LED Array light module is available in red, UV, and IR models. Additionally, an optional diffuser enhances this light module's front lighting performance, and also allows it to be used as a backlight.*



## Models

- White LED Array Module: Model IDWA
- IR LED Array Module: Model IDIA
- Red LED Array Module: Model IDRA

## SPECIFICATIONS

**Note:** All measurements are provided in millimeters (first number) and inches (number in parenthesis).

### Mechanical

#### LED Array

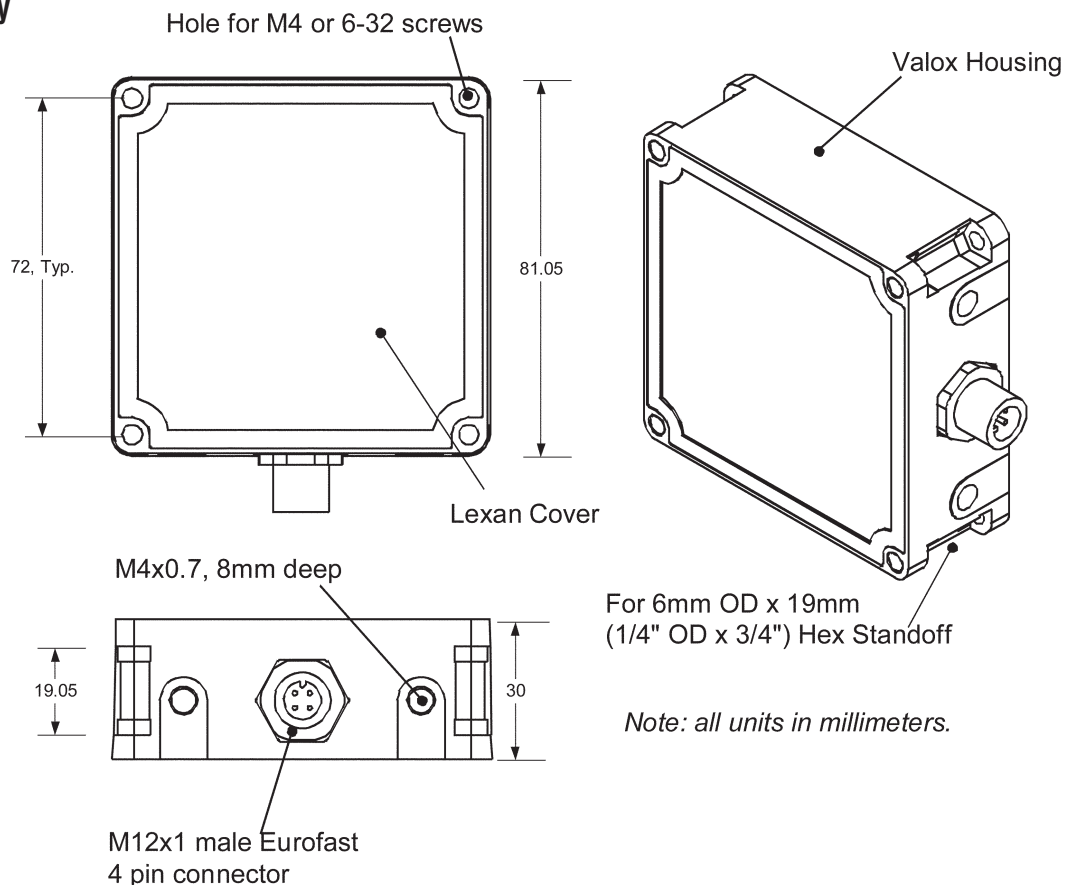

## Electrical

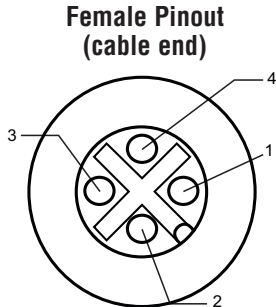

Wire Color	Pin Number*	Function	Breakout Boards		
			CON-IBOB (500 Only)	CON-BRK (600 Only)	In-Sight® CIO-1350/1450
Brown	1	+ 24V	24V	16: V+	24VDC
White	2	No connection	N/A	No connection	N/A
Blue	3	Ground	GND	15: GND	GND
Black	4	Strobe Input signal	IO8	14: or 17-20: IO12	High-speed Output (0/1)

\*See figure at left for this numbering scheme

LED Color	Wavelength	Light Part Number	Max Current	Max Duty Cycle	Max Average Current
Red	670nm	IDRA	1.25 A	15%	188 mA
Infrared	850nm	IDIA	4.5 A	5%	225 mA
White	Not Applicable	IDWA	1.1 A	15%	165 mA

\*General characteristics: Voltage Supply = 24V, Trigger Voltage = 15V, Max single pulse = 50ms

## OPTIONAL ACCESSORIES

### LED Light Bracket (P/N ID0A-BR)

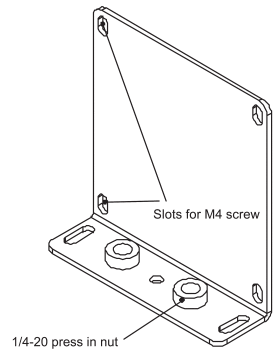
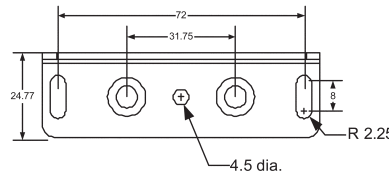
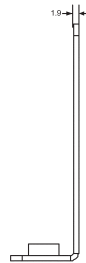
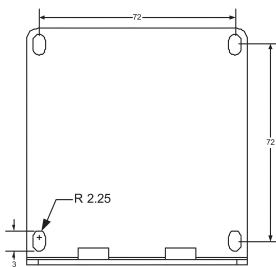

Note: All units in millimeters.

Optional Accessory	Description	Part Number
Standoffs/Screws	Hex Standoffs and screws for LED Array mounting. Includes four 3/4" long 6/32 hex threaded standoffs and four 3/4" long 6/32 socket head screws.	ID0A-SE
LED Array Module Cable	6-meter (19.7 ft) pigtailed cable, M12 connectors with bare wire ends	CBL-P18
LED Array Module Diffuser	51mm (2 in) diffuser for all models	ILC-605



Corporate Headquarters: One Vision Drive, Natick, MA 01760-2059 (508) 650-3000 fax: (508) 650-3344 [www.cognex.com](http://www.cognex.com)  
 Offices: Canada (905) 634-2726 • China +86 21 6407 5835 • France +33 1 4777 1550 • Germany +49 721 6639 0 • Ireland +353 1 825 4420 • Italy +39 02 6747 1200  
 Japan +81 3 5977 5400 • Korea +82 2 539 9047 • Netherlands +31 402 668 565 • Singapore +65 6325 5700 • Sweden +46 21 14 55 88 • Switzerland +41 71 313 06 05  
 Taiwan +886 3 578 0060 • United Kingdom +44 1908 206 000

© Copyright 2005, Cognex Corporation. All information in this document is subject to change without notice. Cognex and In-Sight are registered trademarks of Cognex Corporation. All other trademarks are the property of their respective owners. All rights reserved. Printed in the USA. 12-05