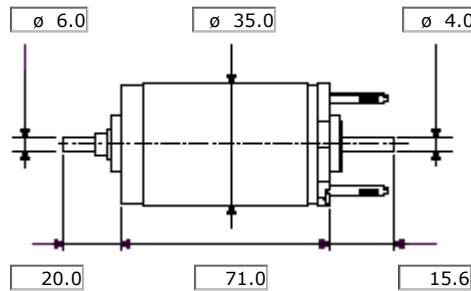

**RE 35****Ø 35 mm, Graphite brushes , 90 Watt**

Dimensions in mm.  
This schematic is not drawn to scale.

**Order no.****273754****Motor data** (provisional)

Power rating	W	90
Nominal voltage	Volt	42.0
No load speed	min <sup>-1</sup>	7530
Stall torque	Nm	1.07
Speed/torque gradient	min <sup>-1</sup> mNm <sup>-1</sup>	7.16
No load current	mA	93
Starting current	A	20.3
Terminal resistance	Ohm	2.07
Max. permissible speed	min <sup>-1</sup>	12000
Max. continuous current	mA	1950
Max. continuous torque	mNm	97.7
Max. power output at nominal voltage	W	206
Max. efficiency	%	86.0
Torque constant	mNm A <sup>-1</sup>	52.5
Speed constant	min <sup>-1</sup> V <sup>-1</sup>	182
Mechanical time constant	ms	5
Rotor inertia	gcm <sup>2</sup>	72.0
Terminal inductance	mH	0.620
Thermal resistance housing-ambient	KW <sup>-1</sup>	6.2
Thermal resistance rotor-housing	KW <sup>-1</sup>	2.0
Thermal time constant winding	s	30

**Specifications**

- Axial play 0.05-0.15 mm
- Max. load of **ball bearings**
  - axial (dynamic) 5.6 N
  - radial ( 5 mm from flange ) 28 N
- Press-fit force (static) 110 N
- (static, shaft supported) 1200 N
- Radial play **ball bearings** 0.025 mm
- Ambient temperature range -20/+100 °C
- Max. rotor temperature +155 °C
- Number of commutator segments 13
- Weight of motor 340 g
- Values listed in the table are nominal.

**Option**

- Hollow shaft as special design
- Preload bearing

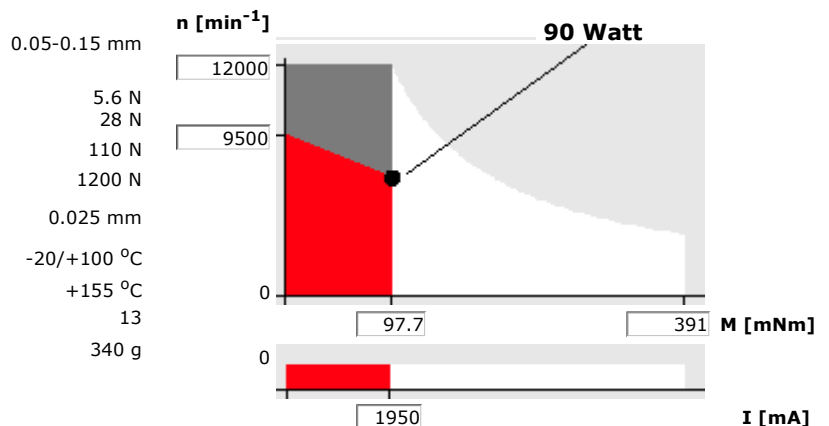
**Operating range****Recommended operating range****Continuous operation****Short term operation****This graph is not drawn to scale.**

