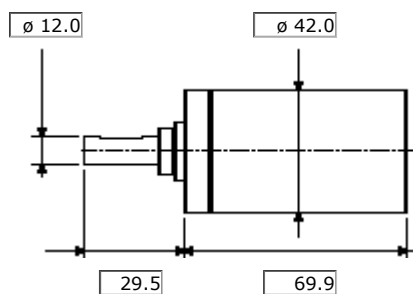

Planetary Gearhead GP 42 C**Ø42 mm, 15 Nm, ball bearing preloaded Ceramic version**

Dimensions in mm.
This schematic is not drawn to scale.

Order no.**203120****Gearhead data**

Reduction		43:1
Number of stages		3
Max. continuous torque at gear output	Nm	15
Intermittently permissible torque at gear output	Nm	23
Sense of rotation, drive to output		=
Max. efficiency	%	72
Weight	g	460
Average backlash, unloaded	°	0.5
Mass inertia	gcm ²	15.0
Gearhead length	mm	69.9
Max. motor shaft diameter	mm	10.0

Technical data

- Planetary Gearhead straight teeth
- Output shaft stainless steel
- Bearing at output ball bearing preloaded
- Radial play , 12.0 mm from flange max. 0.060 mm
- Axial play at axial load < 5 N 0 mm
- > 5 N max. 0.300 mm
- Max. perm. radial load , 12.0 mm from flange 150 N
- Max. perm. axial load max. 150 N
- Max. perm. force for press fit max. 300 N
- Recommended input speed < 8,000 min⁻¹
- Recommended temperature range - 20 ... +100 °C
- Option: extended temperature range - 35 ... +100 °C

