

Planetary Gearhead GP 42 C $\varnothing 42$ mm, 3 - 15 Nm

Ceramic Version

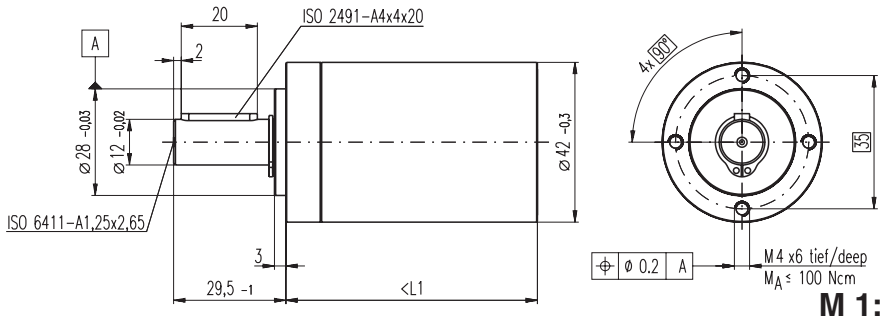

Technical Data

Planetary Gearhead	straight teeth
Output shaft	stainless steel
Bearing at output	preloaded ball bearings
Radial play, 12 mm from flange	max. 0.06 mm
Axial play at axial load	< 5 N 0 mm > 5 N max. 0.3 mm
Max. permissible axial load	150 N
Max. permissible force for press fits	300 N
Sense of rotation, drive to output	=
Recommended input speed	< 8000 rpm
Recommended temperature range	-20 ... +100°C
Extended area as option	-35 ... +100°C
Number of stages	1 2 3 4
Max. radial load, 12 mm from flange	120 N 150 N 150 N 150 N

M 1:2

- Stock program
- Standard program
- Special program (on request)

Order Number

	203113	203115	203119	203120	203124	203129	203128	203133	203137	203141
Gearhead Data										
1 Reduction	3.5 : 1	12 : 1	26 : 1	43 : 1	81 : 1	156 : 1	150 : 1	285 : 1	441 : 1	756 : 1
2 Reduction absolute	7/2	49/4	26	343/8	2197/27	156	2401/16	15379/54	441	756
3 Mass inertia gcm ²	14	15	9.1	15	9.4	9.1	15	15	14	14
4 Max. motor shaft diameter mm	10	10	8	10	8	8	10	10	10	10
Order Number	203114	203116		203121	203125		203130	203134	203138	203142
1 Reduction	4.3 : 1	15 : 1		53 : 1	91 : 1		186 : 1	319 : 1	488 : 1	936 : 1
2 Reduction absolute	13/3	91/6		637/12	91		4459/24	637/2	4394/9	936
3 Mass inertia gcm ²	9.1	15		15	15		15	15	9.4	9.1
4 Max. motor shaft diameter mm	8	10		10	10		10	10	8	8
Order Number		203117		203122	203126		203131	203135	203139	
1 Reduction		19 : 1		66 : 1	113 : 1		230 : 1	353 : 1	546 : 1	
2 Reduction absolute		169/9		1183/18	338/3		8281/36	28561/81	546	
3 Mass inertia gcm ²		9.4		15	9.4		15	9.4	14	
4 Max. motor shaft diameter mm		8		10	8		10	8	10	
Order Number		203118		203123	203127		203132	203136	203140	
1 Reduction		21 : 1		74 : 1	126 : 1		257 : 1	394 : 1	676 : 1	
2 Reduction absolute		21		147/2	126		1029/4	1183/3	676	
3 Mass inertia gcm ²		14		15	14		15	15	9.1	
4 Max. motor shaft diameter mm		10		10	10		10	10	8	
5 Number of stages		1	2	2	3	3	3	4	4	4
6 Max. continuous torque Nm		3.0	7.5	7.5	15.0	15.0	15.0	15.0	15.0	15.0
7 Intermittently permissible torque at gear output Nm		4.5	11.3	11.3	22.5	22.5	22.5	22.5	22.5	22.5
8 Max. efficiency %		90	81	81	72	72	72	64	64	64
9 Weight g		260	360	360	460	460	460	560	560	560
10 Average backlash no load °		0.3	0.4	0.4	0.5	0.5	0.5	0.5	0.5	0.5
11 Gearhead length L1 mm		40.9	55.4	55.4	69.9	69.9	69.9	84.4	84.4	84.4

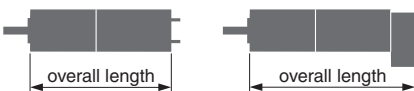

Combination

+ Motor	Page	+ Tacho	Page	+ Brake	Page	Overall length [mm] = Motor length + gearhead length + (tacho / brake) + assembly parts									
RE 35, 90 W	81					111.9	126.4	126.4	140.9	140.9	140.9	155.4	155.4	155.4	155.4
RE 35, 90 W	81	MR	251			123.3	137.8	137.8	152.3	152.3	152.3	166.8	166.8	166.8	166.8
RE 35, 90 W	81	HED_5540	254/256			132.9	147.4	147.4	161.9	161.9	161.9	176.4	176.4	176.4	176.4
RE 35, 90 W	81	DCT 22	263			130.0	144.5	144.5	159.0	159.0	159.0	173.5	173.5	173.5	173.5
RE 35, 90 W	81			AB 28	300	148.0	162.5	162.5	177.0	177.0	177.0	191.5	191.5	191.5	191.5
RE 36, 70 W	82					112.2	126.7	126.7	141.2	141.2	141.2	155.7	155.7	155.7	155.7
RE 36, 70 W	82	MR	251			123.6	138.1	138.1	152.6	152.6	152.6	167.1	167.1	167.1	167.1
RE 36, 70 W	82	HED_5540	254/256			133.2	147.7	147.7	162.2	162.2	162.2	176.7	176.7	176.7	176.7
RE 36, 70 W	82	DCT 22	263			130.3	144.8	144.8	159.3	159.3	159.3	173.8	173.8	173.8	173.8
RE 40, 150 W	83					112.0	126.5	126.5	141.0	141.0	141.0	155.5	155.5	155.5	155.5
RE 40, 150 W	83	MR	251			123.4	137.9	137.9	152.4	152.4	152.4	166.9	166.9	166.9	166.9
RE 40, 150 W	83	HED_5540	254/256			132.7	147.2	147.2	161.7	161.7	161.7	176.2	176.2	176.2	176.2
RE 40, 150 W	83	HEDL 9140	259			166.1	180.6	180.6	195.1	195.1	195.1	209.6	209.6	209.6	209.6
RE 40, 150 W	83			AB 28	300	148.1	162.6	162.6	177.1	177.1	177.1	191.6	191.6	191.6	191.6
RE 40, 150 W	83			AB 28	301	156.1	170.6	170.6	185.1	185.1	185.1	199.6	199.6	199.6	199.6
RE 40, 150 W	83	HED_5540	254/256	AB 28	300	165.2	179.7	179.7	194.2	194.2	194.2	208.7	208.7	208.7	208.7
RE 40, 150 W	83	HEDL 9140	259	AB 28	301	176.6	191.1	191.1	205.6	205.6	205.6	220.1	220.1	220.1	220.1
EC 40, 120 W	163					111.0	125.5	125.5	140.0	140.0	140.0	154.5	154.5	154.5	154.5
EC 40, 120 W	163	HED_5540	255/257			129.4	143.9	143.9	158.4	158.4	158.4	172.9	172.9	172.9	172.9
EC 40, 120 W	163	Res 26	264			137.6	152.1	152.1	166.6	166.6	166.6	181.1	181.1	181.1	181.1
EC 40, 120 W	163			AB 28	300	141.8	156.3	156.3	170.8	170.8	170.8	185.3	185.3	185.3	185.3
EC 45, 150 W	164					152.2	166.7	166.7	181.2	181.2	181.2	195.7	195.7	195.7	195.7
EC 45, 150 W	164	HEDL 9140	259			167.8	182.3	182.3	196.8	196.8	196.8	211.3	211.3	211.3	211.3
EC 45, 150 W	164	Res 26	264			152.2	166.7	166.7	181.2	181.2	181.2	195.7	195.7	195.7	195.7
EC 45, 150 W	164			AB 28	301	159.6	174.1	174.1	188.6	188.6	188.6	203.1	203.1	203.1	203.1

Planetary Gearhead GP 42 C Ø42 mm, 3 - 15 Nm

Ceramic Version

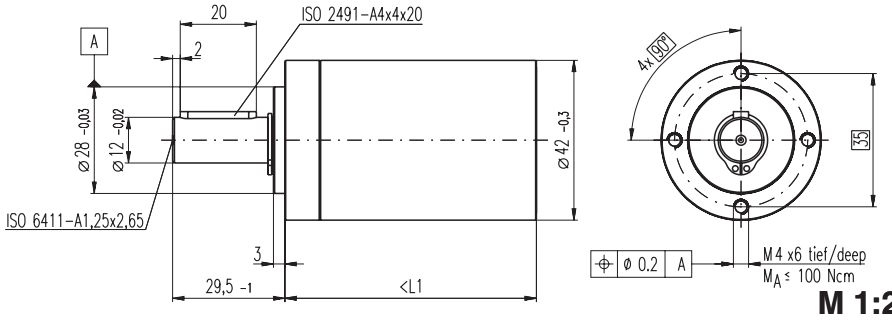

Technical Data

Planetary Gearhead	straight teeth
Output shaft	stainless steel
Bearing at output	preloaded ball bearings
Radial play, 12 mm from flange	max. 0.06 mm
Axial play at axial load	< 5 N 0 mm > 5 N max. 0.3 mm
Max. permissible axial load	150 N
Max. permissible force for press fits	300 N
Sense of rotation, drive to output	=
Recommended input speed	< 8000 rpm
Recommended temperature range	-20 ... +100°C
Extended area as option	-35 ... +100°C
Number of stages	1 2 3 4
Max. radial load, 12 mm from flange	120 N 150 N 150 N 150 N

- Stock program
- Standard program
- Special program (on request)

Order Number

203113	203115	203119	203120	203124	203129	203128	203133	203137	203141
--------	--------	--------	--------	--------	--------	--------	--------	--------	--------

Gearhead Data

	203113	203115	203119	203120	203124	203129	203128	203133	203137	203141
1 Reduction	3.5 : 1	12 : 1	26 : 1	43 : 1	81 : 1	156 : 1	150 : 1	285 : 1	441 : 1	756 : 1
2 Reduction absolute	7/2	49/4	26	343/8	2197/27	156	2401/16	15379/54	441	756
3 Mass inertia gcm ²	14	15	9.1	15	9.4	9.1	15	15	14	14
4 Max. motor shaft diameter mm	10	10	8	10	8	8	10	10	10	10
Order Number	203114	203116		203121	203125		203130	203134	203138	203142
1 Reduction	4.3 : 1	15 : 1		53 : 1	91 : 1		186 : 1	319 : 1	488 : 1	936 : 1
2 Reduction absolute	13/3	91/6		637/12	91		4459/24	637/2	4394/9	936
3 Mass inertia gcm ²	9.1	15		15	15		15	15	9.4	9.1
4 Max. motor shaft diameter mm	8	10		10	10		10	10	8	8
Order Number		203117		203122	203126		203131	203135	203139	
1 Reduction		19 : 1		66 : 1	113 : 1		230 : 1	353 : 1	546 : 1	
2 Reduction absolute		169/9		1183/18	338/3		8281/36	28561/81	546	
3 Mass inertia gcm ²		9.4		15	9.4		15	9.4	14	
4 Max. motor shaft diameter mm		8		10	8		10	8	10	
Order Number		203118		203123	203127		203132	203136	203140	
1 Reduction		21 : 1		74 : 1	126 : 1		257 : 1	394 : 1	676 : 1	
2 Reduction absolute		21		147/2	126		1029/4	1183/3	676	
3 Mass inertia gcm ²		14		15	14		15	15	9.1	
4 Max. motor shaft diameter mm		10		10	10		10	10	8	
5 Number of stages		1	2	2	3	3	3	4	4	4
6 Max. continuous torque Nm		3.0	7.5	7.5	15.0	15.0	15.0	15.0	15.0	15.0
7 Intermittently permissible torque at gear output Nm		4.5	11.3	11.3	22.5	22.5	22.5	22.5	22.5	22.5
8 Max. efficiency %		90	81	81	72	72	72	64	64	64
9 Weight g		260	360	360	460	460	460	560	560	560
10 Average backlash no load °		0.3	0.4	0.4	0.5	0.5	0.5	0.5	0.5	0.5
11 Gearhead length L1 mm		40.9	55.4	55.4	69.9	69.9	69.9	84.4	84.4	84.4

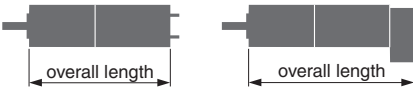

Combination

+ Motor	Page	+ Tacho	Page	+ Brake	Page	Overall length [mm] = Motor length + gearhead length + (tacho / brake) + assembly parts									
EC 45, 250 W	165					185.0	199.5	199.5	214.0	214.0	214.0	228.5	228.5	228.5	228.5
EC 45, 250 W	165	HEDL 9140	259			200.6	215.1	215.1	229.6	229.6	229.6	244.1	244.1	244.1	244.1
EC 45, 250 W	165	Res 26	264			185.0	199.5	199.5	214.0	214.0	214.0	228.5	228.5	228.5	228.5
EC 45, 250 W	165			AB 28	301	192.4	206.9	206.9	221.4	221.4	221.4	235.9	235.9	235.9	235.9
EC 45, 250 W	165	HEDL 9140	259	AB 28	301	209.4	223.9	223.9	238.4	238.4	238.4	252.9	252.9	252.9	252.9
EC-max 30, 60 W	177					105.0	119.5	119.5	134.0	134.0	134.0	148.5	148.5	148.5	148.5
EC-max 30, 60 W	177	MR	251			117.2	131.7	131.7	146.2	146.2	146.2	160.7	160.7	160.7	160.7
EC-max 30, 60 W	177	HEDL 5540	258			125.6	140.1	140.1	154.6	154.6	154.6	169.1	169.1	169.1	169.1
EC-max 30, 60 W	177			AB 20	298	137.1	151.6	151.6	166.1	166.1	166.1	180.6	180.6	180.6	180.6
EC-max 30, 60 W	177	HEDL 5540	250	AB 20	298	157.7	172.2	172.2	186.7	186.7	186.7	201.2	201.2	201.2	201.2
EC-max 40, 70 W	178					99.0	113.5	113.5	128.0	128.0	128.0	142.5	142.5	142.5	142.5
EC-max 40, 70 W	178	MR	251			114.9	129.4	129.4	143.9	143.9	143.9	158.4	158.4	158.4	158.4
EC-max 40, 70 W	178	HEDL 5540	258			122.4	136.9	136.9	151.4	151.4	151.4	165.9	165.9	165.9	165.9
EC-max 40, 70 W	178			AB 28	299	139.0	153.5	153.5	168.0	168.0	168.0	182.5	182.5	182.5	182.5
EC-max 40, 70 W	178	HEDL 5540	258	AB 28	299	162.4	176.9	176.9	191.4	191.4	191.4	205.9	205.9	205.9	205.9
EC-power 30, 100 W	185					88.0	102.5	102.5	117.0	117.0	117.0	131.5	131.5	131.5	131.5
EC-power 30, 100 W	185	MR	251			100.2	114.7	114.7	129.2	129.2	129.2	143.7	143.7	143.7	143.7
EC-power 30, 100 W	185	HEDL 5540	258			108.6	123.1	123.1	137.6	137.6	137.6	152.1	152.1	152.1	152.1
EC-power 30, 100 W	185			AB 20	298	120.1	134.6	134.6	149.1	149.1	149.1	163.6	163.6	163.6	163.6
EC-power 30, 100 W	185	HEDL 5540	258	AB 20	298	140.7	155.2	155.2	169.7	169.7	169.7	184.2	184.2	184.2	184.2
EC-power 30, 200 W	186					105.0	119.5	119.5	134.0	134.0	134.0	148.5	148.5	148.5	148.5
EC-power 30, 200 W	186	MR	251			117.2	131.7	131.7	146.2	146.2	146.2	160.7	160.7	160.7	160.7
EC-power 30, 200 W	186	HEDL 5540	258			125.6	140.1	140.1	154.6	154.6	154.6	169.1	169.1	169.1	169.1
EC-power 30, 200 W	186			AB 20	298	137.1	151.6	151.6	166.1	166.1	166.1	180.6	180.6	180.6	180.6
EC-power 30, 200 W	186	HEDL 5540	258	AB 20	298	157.7	172.2	172.2	186.7	186.7	186.7	201.2	201.2	201.2	201.2
MCD EPOS, 60 W	295					161.0	175.5	175.5	190.0	190.0	190.0	204.5	204.5	204.5	204.5
MCD EPOS P, 60 W	295					161.0	175.5	175.5	190.0	190.0	190.0	204.5	204.5	204.5	204.5