

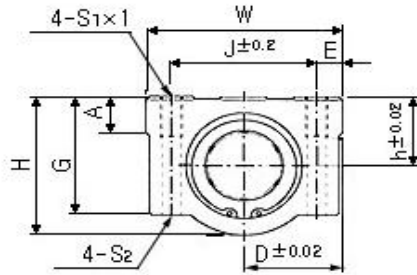

SC_WUU

Pillow Block Housing + 2xLM_UU Bearings



Long type	Dimensions(mm)													Fixing Holes			
	Part number	Installed Bearing	Load		Wgt. (gf)	Shaft Dia.	h	D	W	H	G	A	J	E	S1 x l	S2	Center
SC8WUU	2xLM8UU	410	800	94	8	11	17	34	22	18	6	24	5	M4x8	3.4	42	58
SC10WUU	2xLM10UU	590	1080	147	10	13	20	40	26	21	8	28	6	M5x12	4.3	46	68
SC12WUU	2xLM12UU	650	1180	220	12	15	21	42	28	24	7.4	30.5	5.75	M5x12	4.3	64	77
SC13WUU	2xLM13UU	800	1540	245	13	15	22	44	30	24.5	8	33	5.5	M5x12	4.3	64	77
SC16WUU	2xLM16UU	1230	2340	376	16	19	25	50	38.5	32.5	9	36	7	M5x12	4.3	79	89
SC20WUU	2xLM20UU	1370	2740	476	20	21	27	54	41	35	11	40	7	M6x12	5.2	90	100
SC25WUU	2xLM25UU	1560	3120	1115	25	26	38	76	51.5	41	12	54	11	M8x18	6.8	119	136
SC30WUU	2xLM30UU	3490	5480	1375	30	30	39	78	59.5	49	15	58	10	M8x18	6.8	132	146
SC35WUU	2xLM35UU	2650	6260	2200	35	34	45	90	68	54	18	70	10	M8x18	6.8	140	160
SC40WUU	2xLM40UU	3440	8020	3200	40	40	51	102	78	62	20	80	11	M10x25	8.6	150	180
SC50WUU	2xLM50UU	6110	15860	6720	50	52	61	122	102	80	24	100	11	M10x25	8.6	200	230

N.B. Part No LM_UU - With wipers / seals at both ends

User Guide:

Linear Bearings are designed to be assembled to Round Rails with a hardness of $\geq 55\text{Hrc}$
 (Assembly to our Round Rail part numbers: W, WV and WRA)