

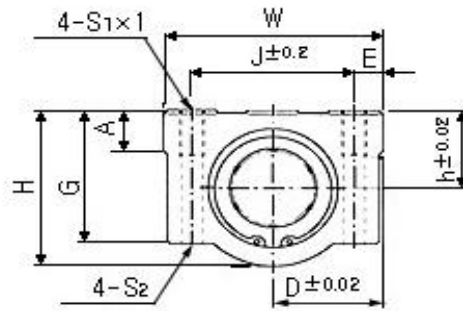

# SC\_UU

## Standard Housing Assembled with Linear Bearing



Standard type		Dimensions(mm)											Fixing Holes				
Part number	Installed Bearing	Load Ratings		Wgt. (g)	Shaft Dia.	h	D	W	H	G	A	J	E	S1 x I	S2	C e n t r e	L e n g t h
		C(N)	CO (N)														
SC8UU	LM8UU	260	400	56	8	11	17	34	22	18	6	24	5	M4x8	3.4	18	30
SC10UU	LM10UU	370	540	90	10	13	20	40	26	21	8	28	6	M5x10	4.3	21	35
SC12UU	LM12UU	410	590	112	12	15	22	44	30	24.5	8	31	5.5	M5x10	4.3	26	39
SC13UU	LM13UU	500	770	123	13	15	22	44	30	24.5	8	33	5.5	M5x10	4.3	26	39
SC16UU	LM16UU	770	1170	189	16	19	25	50	38.5	32.5	9	36	7	M5x12	4.3	34	44
SC20UU	LM20UU	860	1370	237	20	21	27	54	41	35	11	40	7	M6x12	5.2	40	50
SC25UU	LM25UU	980	1560	555	25	26	38	76	51.5	41	12	54	11	M8x18	6.8	50	67
SC30UU	LM30UU	1560	2740	685	30	30	39	78	59.5	49	15	58	10	M8x18	6.8	58	72
SC35UU	LM35UU	1660	3130	1100	35	34	45	90	68	54	18	70	10	M8x18	6.8	60	80
SC40UU	LM40UU	2150	4010	1600	40	40	51	102	78	62	20	80	11	M10x25	8.6	60	90
SC50UU	LM50UU	3820	7930	3350	50	52	61	122	102	80	25	100	11	M10x25	8.6	80	110

N.B. Part No LM\_UU - With wipers / seals at both ends

### User Guide:

Linear Bearings are designed to be assembled to Round Rails with hardness of  $\geq 55\text{Hrc}$   
 (Assembly to our part numbers: W, WV and WRA)